

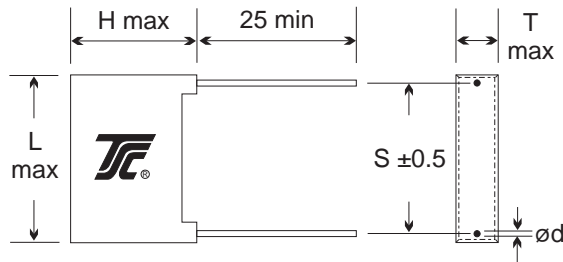

Metallized Polypropylene • Radial Box

TYPE: P102 Series



L	10.5	13.0	18.0	26.5	32.0
S	7.5	10.0	15.0	22.5	27.5
d	0.6	0.6	0.8	0.8	0.8

(mm)

CAP. (µF)	160 VDC				250 VDC			
	T	H	L	Part No.	T	H	L	Part No.
0.001	4.0	9.0	10.5	102P102A161K	4.0	9.0	10.5	102P102A251K
0.0012	4.0	9.0	10.5	122P102A161K	4.0	9.0	10.5	122P102A251K
0.0015	4.0	9.0	10.5	152P102A161K	4.0	9.0	10.5	152P102A251K
0.0018	4.0	9.0	10.5	182P102A161K	4.0	9.0	10.5	182P102A251K
0.0022	4.0	9.0	10.5	222P102A161K	4.0	9.0	10.5	222P102A251K
0.0027	4.0	9.0	10.5	272P102A161K	4.0	9.0	10.5	272P102A251K
0.0033	4.0	9.0	10.5	332P102A161K	4.0	9.0	10.5	332P102A251K
0.0039	4.0	9.0	10.5	392P102A161K	4.0	9.0	10.5	392P102A251K
0.0047	4.0	9.0	10.5	472P102A161K	4.0	9.0	10.5	472P102A251K
0.0056	4.0	9.0	10.5	562P102A161K	4.0	9.0	10.5	562P102A251K
0.0068	4.0	9.0	10.5	682P102A161K	4.0	9.0	10.5	682P102A251K
0.0082	4.0	9.0	10.5	822P102A161K	4.0	9.0	10.5	822P102A251K
0.01	4.0	9.0	10.5	103P102A161K	4.0	9.0	10.5	103P102A251K
0.012	4.0	9.0	10.5	123P102A161K	4.0	9.0	10.5	123P102A251K
0.015	4.0	9.0	10.5	153P102A161K	4.0	9.0	10.5	153P102A251K
0.018	4.0	9.0	10.5	183P102A161K	4.0	9.0	10.5	183P102A251K
0.022	4.0	9.0	10.5	223P102A161K	4.0	9.0	10.5	223P102A251K
0.027	4.0	9.0	10.5	273P102A161K	4.0	9.0	13.0	273P102A251K
0.033	4.0	9.0	10.5	333P102A161K	4.0	9.0	13.0	333P102A251K
0.039	4.0	9.0	10.5	393P102A161K	5.0	11.0	13.0	393P102A251K
0.047	4.0	9.0	10.5	473P102A161K	5.0	11.0	13.0	473P102A251K
0.056	4.0	9.0	13.0	563P102A161K	6.0	12.0	13.0	563P102A251K
0.068	4.0	9.0	13.0	683P102A161K	6.0	12.0	13.0	683P102A251K
0.082	4.0	9.0	13.0	823P102A161K	5.0	11.0	18.0	823P102A251K
0.10	5.0	11.0	13.0	104P102A161K	5.0	11.0	18.0	104P102A251K
0.12	5.0	11.0	13.0	124P102A161K	6.0	12.0	18.0	124P102A251K
0.15	6.0	12.0	13.0	154P102A161K	6.0	12.0	18.0	154P102A251K
0.18	5.0	11.0	18.0	184P102A161K	7.5	13.5	18.0	184P102A251K
0.22	5.0	11.0	18.0	224P102A161K	7.5	13.5	18.0	224P102A251K
0.27	6.0	12.0	18.0	274P102A161K	8.5	15.0	18.0	274P102A251K
0.33	6.0	12.0	18.0	334P102A161K	8.5	15.0	18.0	334P102A251K
0.39	7.5	13.5	18.0	394P102A161K	7.0	16.5	26.5	394P102A251K
0.47	7.5	13.5	18.0	474P102A161K	8.5	17.0	26.5	474P102A251K
0.56	8.5	15.0	18.0	564P102A161K	8.5	17.0	26.5	564P102A251K
0.68	8.5	15.0	18.0	684P102A161K	10.0	19.0	26.5	684P102A251K
0.82	7.0	16.5	26.5	824P102A161K	11.0	20.0	32.0	824P102A251K
1.0	8.5	17.0	26.5	105P102A161K	11.0	20.0	32.0	105P102A251K
1.2	8.5	17.0	26.5	125P102A161K	11.0	20.0	32.0	125P102A251K
1.5	10.0	19.0	26.5	155P102A161K	13.0	22.0	32.0	155P102A251K
1.8	11.0	20.0	32.0	185P102A161K	15.0	25.0	32.0	185P102A251K
2.2	11.0	20.0	32.0	225P102A161K	15.0	25.0	32.0	225P102A251K
2.7	11.0	20.0	32.0	275P102A161K	18.0	30.0	32.0	275P102A251K
3.3	13.0	22.0	32.0	335P102A161K	18.0	30.0	32.0	335P102A251K
3.9	15.0	25.0	32.0	395P102A161K	18.0	30.0	32.0	395P102A251K
4.7	15.0	25.0	32.0	475P102A161K	18.0	30.0	32.0	475P102A251K
5.6	18.0	30.0	32.0	565P102A161K				
6.8	18.0	30.0	32.0	685P102A161K				
8.2	18.0	30.0	32.0	825P102A161K				
10.0	18.0	30.0	32.0	106P102A161K				

*Other Values, Voltages, And Dimensions Are Available On Request



Metallized Polypropylene • Radial Box

TYPE: P102 Series

(mm)

CAP. (μF)	400 VDC				630 VDC			
	T	H	L	Part No.	T	H	L	Part No.
0.001	4.0	9.0	10.5	102P102A401K	4.0	9.0	10.5	102P102A631K
0.0012	4.0	9.0	10.5	122P102A401K	4.0	9.0	10.5	122P102A631K
0.0015	4.0	9.0	10.5	152P102A401K	4.0	9.0	10.5	152P102A631K
0.0018	4.0	9.0	10.5	182P102A401K	4.0	9.0	10.5	182P102A631K
0.0022	4.0	9.0	10.5	222P102A401K	4.0	9.0	10.5	222P102A631K
0.0027	4.0	9.0	10.5	272P102A401K	4.0	9.0	10.5	272P102A631K
0.0033	4.0	9.0	10.5	332P102A401K	4.0	9.0	10.5	332P102A631K
0.0039	4.0	9.0	10.5	392P102A401K	4.0	9.0	13.0	392P102A631K
0.0047	4.0	9.0	10.5	472P102A401K	4.0	9.0	13.0	472P102A631K
0.0056	4.0	9.0	10.5	562P102A401K	4.0	9.0	13.0	562P102A631K
0.0068	4.0	9.0	10.5	682P102A401K	4.0	9.0	13.0	682P102A631K
0.0082	4.0	9.0	10.5	822P102A401K	4.0	9.0	13.0	822P102A631K
0.01	4.0	9.0	10.5	103P102A401K	5.0	11.0	13.0	103P102A631K
0.012	4.0	9.0	13.0	123P102A401K	5.0	11.0	13.0	123P102A631K
0.015	4.0	9.0	13.0	153P102A401K	6.0	12.0	13.0	153P102A631K
0.018	4.0	9.0	13.0	183P102A401K	5.0	11.0	18.0	183P102A631K
0.022	5.0	11.0	13.0	223P102A401K	6.0	12.0	18.0	223P102A631K
0.027	5.0	11.0	13.0	273P102A401K	6.0	12.0	18.0	273P102A631K
0.033	6.0	11.0	13.0	333P102A401K	6.0	12.0	18.0	333P102A631K
0.039	5.0	12.0	13.0	393P102A401K	7.5	13.5	18.0	393P102A631K
0.047	5.0	12.0	13.0	473P102A401K	7.5	13.5	18.0	473P102A631K
0.056	6.0	11.0	18.0	563P102A401K	7.5	13.5	18.0	563P102A631K
0.068	6.0	12.0	18.0	683P102A401K	8.5	15.0	18.0	683P102A631K
0.082	7.5	12.0	18.0	823P102A401K	7.0	16.5	26.5	823P102A631K
0.10	7.5	13.5	18.0	104P102A401K	8.5	17.0	26.5	104P102A631K
0.12	8.5	15.0	18.0	124P102A401K	8.5	17.0	26.5	124P102A631K
0.15	8.5	15.0	18.0	154P102A401K	10.0	19.0	26.5	154P102A631K
0.18	7.0	16.5	26.5	184P102A401K	11.0	20.0	32.0	184P102A631K
0.22	8.5	17.0	26.5	224P102A401K	11.0	20.0	32.0	224P102A631K
0.27	8.5	17.0	26.5	274P102A401K	11.0	20.0	32.0	274P102A631K
0.33	10.0	19.0	26.5	334P102A401K	13.0	22.0	32.0	334P102A631K
0.39	11.0	20.0	32.0	394P102A401K	13.0	22.0	32.0	394P102A631K
0.47	11.0	20.0	32.0	474P102A401K	15.0	25.0	32.0	474P102A631K
0.56	11.0	20.0	32.0	564P102A401K	15.0	25.0	32.0	564P102A631K
0.68	13.0	22.0	32.0	684P102A401K	18.0	30.0	32.0	684P102A631K
0.82	15.0	22.0	32.0	824P102A401K	18.0	30.0	32.0	824P102A631K
1.0	15.0	25.0	32.0	105P102A401K	18.0	30.0	32.0	105P102A631K
1.2	18.0	25.0	32.0	125P102A401K				
1.5	18.0	30.0	32.0	155P102A401K				
1.8	18.0	30.0	32.0	185P102A401K				
2.2	18.0	30.0	32.0	225P102A401K				

*Other Values, Voltages, And Dimensions Are Available On Request



Metallized Polypropylene • Radial Epoxy Dipped

TYPE: P104 Series

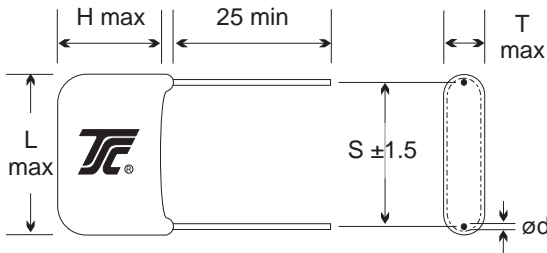

L	10.0	12.5	18.0	26.0	31.0
S	7.5	10.0	15.0	22.5	27.5
d	0.6	0.6	0.8	0.8	0.8

(mm)

CAP. (μ F)	160 VDC				250 VDC			
	T	H	L	Part No.	T	H	L	Part No.
0.001	4.0	8.0	10.0	102P104A161K	4.0	8.0	10.0	102P104A251K
0.0012	4.0	8.0	10.0	122P104A161K	4.0	8.0	10.0	122P104A251K
0.0015	4.0	8.0	10.0	152P104A161K	4.0	8.0	10.0	152P104A251K
0.0018	4.0	8.0	10.0	182P104A161K	4.0	8.0	10.0	182P104A251K
0.0022	4.0	8.0	10.0	222P104A161K	4.0	8.0	10.0	222P104A251K
0.0027	4.0	8.0	10.0	272P104A161K	4.0	8.0	10.0	272P104A251K
0.0033	4.0	8.0	10.0	332P104A161K	4.0	8.0	10.0	332P104A251K
0.0039	4.0	8.0	10.0	392P104A161K	4.0	8.0	10.0	392P104A251K
0.0047	4.0	8.0	10.0	472P104A161K	4.0	8.0	10.0	472P104A251K
0.0056	4.0	8.0	10.0	562P104A161K	4.0	8.0	10.0	562P104A251K
0.0068	4.0	8.0	10.0	682P104A161K	4.0	8.0	10.0	682P104A251K
0.0082	4.0	8.0	10.0	822P104A161K	4.0	8.0	10.0	822P104A251K
0.01	4.0	8.0	10.0	103P104A161K	4.0	8.0	10.0	103P104A251K
0.012	4.0	8.0	10.0	123P104A161K	4.0	8.0	10.0	123P104A251K
0.015	4.0	8.0	10.0	153P104A161K	4.0	8.5	10.0	153P104A251K
0.018	4.0	8.0	10.0	183P104A161K	4.0	8.5	10.0	183P104A251K
0.022	4.0	8.0	10.0	223P104A161K	4.0	9.0	10.0	223P104A251K
0.027	4.0	8.5	10.0	273P104A161K	4.0	8.5	12.5	273P104A251K
0.033	4.0	8.5	10.0	333P104A161K	4.5	9.0	12.5	333P104A251K
0.039	4.0	9.0	10.0	393P104A161K	5.0	10.0	12.5	393P104A251K
0.047	4.0	9.0	10.0	473P104A161K	5.5	10.5	12.5	473P104A251K
0.056	4.0	9.0	12.5	563P104A161K	5.5	11.0	12.5	563P104A251K
0.068	4.0	9.0	12.5	683P104A161K	6.0	12.0	12.5	683P104A251K
0.082	4.5	9.0	12.5	823P104A161K	5.0	10.0	18.0	823P104A251K
0.10	4.5	9.5	12.5	104P104A161K	5.5	11.0	18.0	104P104A251K
0.12	5.0	10.0	12.5	124P104A161K	6.0	12.0	18.0	124P104A251K
0.15	5.5	11.0	12.5	154P104A161K	6.5	12.5	18.0	154P104A251K
0.18	5.0	10.0	18.0	184P104A161K	7.0	13.0	18.0	184P104A251K
0.22	5.5	11.0	18.0	224P104A161K	7.5	14.0	18.0	224P104A251K
0.27	6.0	12.0	18.0	274P104A161K	8.0	15.0	18.0	274P104A251K
0.33	6.5	12.5	18.0	334P104A161K	9.0	16.5	18.0	334P104A251K
0.39	7.0	13.0	18.0	394P104A161K	8.0	14.5	26.0	394P104A251K
0.47	7.5	13.5	18.0	474P104A161K	8.5	15.0	26.0	474P104A251K
0.56	8.0	14.5	18.0	564P104A161K	9.0	16.5	26.0	564P104A251K
0.68	8.5	16.0	18.0	684P104A161K	9.5	18.0	26.0	684P104A251K
0.82	8.0	14.5	26.0	824P104A161K	9.5	17.0	31.0	824P104A251K
1.0	8.5	16.0	26.0	105P104A161K	10.0	19.0	31.0	105P104A251K
1.2	9.0	16.5	26.0	125P104A161K	11.0	20.0	31.0	125P104A251K
1.5	9.5	18.0	26.0	155P104A161K	12.5	23.0	31.0	155P104A251K
1.8	9.5	18.0	31.0	185P104A161K	13.0	24.0	31.0	185P104A251K
2.2	10.0	20.0	31.0	225P104A161K	14.0	26.0	31.0	225P104A251K
2.7	11.5	21.0	31.0	275P104A161K	15.5	28.0	31.0	275P104A251K
3.3	12.5	23.0	31.0	335P104A161K	17.5	31.0	31.0	335P104A251K
3.9	13.5	25.0	31.0	395P104A161K	19.0	33.0	31.0	395P104A251K
4.7	15.0	26.0	31.0	475P104A161K	22.0	36.0	31.0	475P104A251K
5.6	16.0	28.0	31.0	565P104A161K				
6.8	17.0	30.0	31.0	685P104A161K				
8.2	19.0	32.0	31.0	825P104A161K				
10.0	21.0	35.0	31.0	106P104A161K				

*Other Values, Voltages, And Dimensions Are Available On Request



Metallized Polypropylene • Radial Epoxy Dipped

TYPE: P104 Series

(mm)								
CAP. (μ F)	400 VDC				630 VDC			
	T	H	L	Part No.	T	H	L	Part No.
0.001	4.0	8.0	10.0	102P104A401K	4.0	8.0	10.0	102P104A631K
0.0012	4.0	8.0	10.0	122P104A401K	4.0	8.5	10.0	122P104A631K
0.0015	4.0	8.0	10.0	152P104A401K	4.0	8.5	10.0	152P104A631K
0.0018	4.0	8.0	10.0	182P104A401K	4.0	9.0	10.0	182P104A631K
0.0022	4.0	8.0	10.0	222P104A401K	4.0	9.0	10.0	222P104A631K
0.0027	4.0	8.0	10.0	272P104A401K	4.0	9.0	10.0	272P104A631K
0.0033	4.0	8.5	10.0	332P104A401K	4.0	9.0	10.0	332P104A631K
0.0039	4.0	8.5	10.0	392P104A401K	4.0	8.5	12.5	392P104A631K
0.0047	4.0	9.0	10.0	472P104A401K	4.0	9.0	12.5	472P104A631K
0.0056	4.0	9.0	10.0	562P104A401K	4.0	9.0	12.5	562P104A631K
0.0068	4.5	9.0	10.0	682P104A401K	4.5	9.0	12.5	682P104A631K
0.0082	4.5	9.0	10.0	822P104A401K	5.0	9.5	12.5	822P104A631K
0.01	4.5	9.0	10.0	103P104A401K	5.0	10.0	12.5	103P104A631K
0.012	4.0	8.5	12.5	123P104A401K	5.5	11.0	12.5	123P104A631K
0.015	4.5	9.0	12.5	153P104A401K	6.0	12.0	12.5	153P104A631K
0.018	4.5	9.0	12.5	183P104A401K	5.5	11.0	18.0	183P104A631K
0.022	5.0	9.5	12.5	223P104A401K	6.0	12.0	18.0	223P104A631K
0.027	5.0	10.0	12.5	273P104A401K	6.5	12.0	18.0	273P104A631K
0.033	5.5	11.0	12.5	333P104A401K	6.5	12.5	18.0	333P104A631K
0.039	6.0	12.0	12.5	393P104A401K	7.0	13.0	18.0	393P104A631K
0.047	6.5	12.5	12.5	473P104A401K	7.5	13.5	18.0	473P104A631K
0.056	5.5	11.0	18.0	563P104A401K	8.0	14.0	18.0	563P104A631K
0.068	6.5	12.5	18.0	683P104A401K	8.5	16.0	18.0	683P104A631K
0.082	7.0	13.0	18.0	823P104A401K	8.0	14.0	26.0	823P104A631K
0.10	7.5	14.0	18.0	104P104A401K	8.5	16.0	26.0	104P104A631K
0.12	8.0	14.5	18.0	124P104A401K	9.0	16.5	26.0	124P104A631K
0.15	8.5	16.0	18.0	154P104A401K	9.5	18.0	26.0	154P104A631K
0.18	8.0	14.0	26.0	184P104A401K	9.5	17.0	31.0	184P104A631K
0.22	8.5	16.0	26.0	224P104A401K	10.0	19.0	31.0	224P104A631K
0.27	9.0	16.5	26.0	274P104A401K	10.5	20.0	31.0	274P104A631K
0.33	9.5	18.0	26.0	334P104A401K	12.0	22.0	31.0	334P104A631K
0.39	9.5	18.0	31.0	394P104A401K	13.0	23.0	31.0	394P104A631K
0.47	10.0	19.0	31.0	474P104A401K	14.0	25.0	31.0	474P104A631K
0.56	11.0	20.0	31.0	564P104A401K	15.0	27.0	31.0	564P104A631K
0.68	12.0	22.0	31.0	684P104A401K	17.0	30.0	31.0	684P104A631K
0.82	13.0	23.0	31.0	824P104A401K	19.0	33.0	31.0	824P104A631K
1.0	14.0	25.0	31.0	105P104A401K	21.0	35.0	31.0	105P104A631K
1.2	15.0	27.0	31.0	125P104A401K				
1.5	17.0	30.0	31.0	155P104A401K				
1.8	19.0	33.0	31.0	185P104A401K				
2.2	20.5	35.0	31.0	225P104A401K				

*Other Values, Voltages, And Dimensions Are Available On Request



Metallized Polypropylene - Axial Oval Wrap & Fill

TYPE: P106 Series

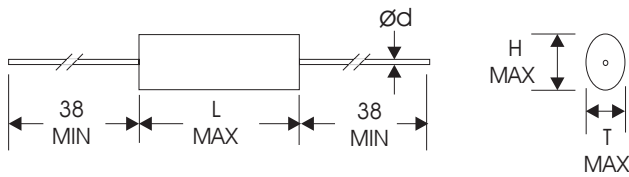

L	11.0	14.0	19.0	26.5	32.0	45.0	58.0
d	0.5	0.6	0.6	0.8	0.8	0.8	1.0

(mm)

CAP. (μ F)	160 VDC				250 VDC			
	T	H	L	Part No.	T	H	L	Part No.
0.001	3.5	6.0	11.0	102P106A161K	3.5	6.0	11.0	102P106A251K
0.0012	3.5	6.0	11.0	122P106A161K	3.5	6.0	11.0	122P106A251K
0.0015	3.5	6.0	11.0	152P106A161K	3.5	6.0	11.0	152P106A251K
0.0018	3.5	6.0	11.0	182P106A161K	3.5	6.0	11.0	182P106A251K
0.0022	3.5	6.0	11.0	222P106A161K	3.5	6.0	11.0	222P106A251K
0.0027	3.5	6.0	11.0	272P106A161K	3.5	6.0	11.0	272P106A251K
0.0033	3.5	6.0	11.0	332P106A161K	3.5	6.0	11.0	332P106A251K
0.0039	3.5	6.0	11.0	392P106A161K	3.5	6.0	11.0	392P106A251K
0.0047	3.5	6.0	11.0	472P106A161K	3.5	6.0	11.0	472P106A251K
0.0056	3.5	6.0	11.0	562P106A161K	3.5	6.0	11.0	562P106A251K
0.0068	3.5	6.0	11.0	682P106A161K	3.5	6.0	11.0	682P106A251K
0.0082	3.5	6.0	11.0	822P106A161K	3.5	6.0	11.0	822P106A251K
0.01	3.5	6.0	11.0	103P106A161K	3.5	6.0	11.0	103P106A251K
0.012	3.5	6.0	11.0	123P106A161K	3.5	6.0	11.0	123P106A251K
0.015	3.5	6.0	11.0	153P106A161K	3.5	6.0	11.0	153P106A251K
0.018	3.5	6.0	11.0	183P106A161K	3.5	6.0	11.0	183P106A251K
0.022	3.5	6.0	11.0	223P106A161K	3.5	6.0	11.0	223P106A251K
0.027	3.5	6.0	11.0	273P106A161K	3.5	6.0	14.0	273P106A251K
0.033	3.5	6.0	11.0	333P106A161K	3.5	6.5	14.0	333P106A251K
0.039	3.5	6.0	11.0	393P106A161K	4.0	7.0	14.0	393P106A251K
0.047	3.5	6.5	11.0	473P106A161K	4.5	8.0	14.0	473P106A251K
0.056	3.5	6.0	14.0	563P106A161K	4.5	8.5	14.0	563P106A251K
0.068	3.5	6.0	14.0	683P106A161K	5.0	9.5	14.0	683P106A251K
0.082	3.5	6.5	14.0	823P106A161K	4.0	7.5	19.0	823P106A251K
0.10	4.0	7.0	14.0	104P106A161K	4.5	8.5	19.0	104P106A251K
0.12	4.0	7.5	14.0	124P106A161K	5.0	9.0	19.0	124P106A251K
0.15	4.5	8.0	14.0	154P106A161K	5.0	10.0	19.0	154P106A251K
0.18	4.0	7.5	19.0	184P106A161K	5.5	11.0	19.0	184P106A251K
0.22	4.5	8.0	19.0	224P106A161K	6.0	12.0	19.0	224P106A251K
0.27	5.0	9.0	19.0	274P106A161K	5.5	11.0	26.5	274P106A251K
0.33	5.0	10.0	19.0	334P106A161K	6.0	12.0	26.5	334P106A251K
0.39	5.5	11.0	19.0	394P106A161K	6.5	12.5	26.5	394P106A251K
0.47	6.0	12.0	19.0	474P106A161K	7.0	13.0	26.5	474P106A251K
0.56	5.5	11.0	26.5	564P106A161K	7.5	13.5	26.5	564P106A251K
0.68	6.0	12.0	26.5	684P106A161K	8.0	15.0	26.5	684P106A251K
0.82	6.5	12.5	26.5	824P106A161K	7.5	13.5	32.0	824P106A251K
1.0	7.0	13.0	26.5	105P106A161K	8.5	15.0	32.0	105P106A251K
1.2	7.5	13.5	26.5	125P106A161K	9.0	16.5	32.0	125P106A251K
1.5	8.5	15.5	26.5	155P106A161K	9.5	18.0	32.0	155P106A251K
1.8	8.0	14.0	32.0	185P106A161K	10.0	19.0	32.0	185P106A251K
2.2	8.5	15.5	32.0	225P106A161K	11.5	21.5	32.0	225P106A251K
2.7	9.0	17.0	32.0	275P106A161K	10.5	20.0	45.0	275P106A251K
3.3	9.5	19.0	32.0	335P106A161K	12.0	22.0	45.0	335P106A251K
3.9	10.5	20.0	32.0	395P106A161K	13.0	24.0	45.0	395P106A251K
4.7	12.0	22.0	32.0	475P106A161K	14.5	26.0	45.0	475P106A251K
5.6	10.5	20.0	45.0	565P106A161K	16.0	27.0	45.0	565P106A251K
6.8	12.0	22.0	45.0	685P106A161K	18.5	30.0	45.0	685P106A251K
8.2	13.0	24.0	45.0	825P106A161K	17.5	28.0	58.0	825P106A251K
10.0	14.5	25.0	45.0	106P106A161K	19.5	32.0	58.0	106P106A251K
12.0	16.0	27.0	45.0	126P106A161K	21.5	36.0	58.0	126P106A251K
15.0	19.0	32.0	45.0	156P106A161K	24.0	40.0	58.0	156P106A251K
18.0	17.5	28.0	58.0	186P106A161K	26.0	42.0	58.0	186P106A251K
22.0	19.0	32.0	58.0	226P106A161K	30.0	46.0	58.0	226P106A251K

*Other Values, Voltages, And Dimensions Are Available On Request



Metallized Polypropylene • Axial Oval Wrap & Fill

TYPE: P106 Series

(mm)

CAP. (μ F)	400 VDC				630 VDC			
	T	H	L	Part No.	T	H	L	Part No.
0.001	3.5	6.0	11.0	102P106A401K	3.5	6.0	11.0	102P106A631K
0.0012	3.5	6.0	11.0	122P106A401K	3.5	6.0	11.0	122P106A631K
0.0015	3.5	6.0	11.0	152P106A401K	3.5	6.0	11.0	152P106A631K
0.0018	3.5	6.0	11.0	182P106A401K	3.5	6.0	11.0	182P106A631K
0.0022	3.5	6.0	11.0	222P106A401K	3.5	6.0	11.0	222P106A631K
0.0027	3.5	6.0	11.0	272P106A401K	3.5	6.0	11.0	272P106A631K
0.0033	3.5	6.0	11.0	332P106A401K	3.5	6.5	11.0	332P106A631K
0.0039	3.5	6.0	11.0	392P106A401K	3.5	6.0	14.0	392P106A631K
0.0047	3.5	6.0	11.0	472P106A401K	3.5	6.5	14.0	472P106A631K
0.0056	3.5	6.0	11.0	562P106A401K	3.5	6.5	14.0	562P106A631K
0.0068	3.5	6.0	11.0	682P106A401K	3.5	6.5	14.0	682P106A631K
0.0082	3.5	6.0	11.0	822P106A401K	4.0	7.0	14.0	822P106A631K
0.01	3.5	6.0	11.0	103P106A401K	4.0	7.5	14.0	103P106A631K
0.012	3.5	6.0	14.0	123P106A401K	4.5	8.0	14.0	123P106A631K
0.015	3.5	6.0	14.0	153P106A401K	5.0	9.0	14.0	153P106A631K
0.018	3.5	6.5	14.0	183P106A401K	4.5	8.0	19.0	183P106A631K
0.022	4.0	7.0	14.0	223P106A401K	5.0	9.0	19.0	223P106A631K
0.027	4.0	7.5	14.0	273P106A401K	5.0	10.0	19.0	273P106A631K
0.033	4.5	8.0	14.0	333P106A401K	5.5	10.5	19.0	333P106A631K
0.039	4.5	9.0	14.0	393P106A401K	6.0	11.0	19.0	393P106A631K
0.047	5.0	9.5	14.0	473P106A401K	6.0	12.0	19.0	473P106A631K
0.056	4.5	8.5	19.0	563P106A401K	6.5	12.5	19.0	563P106A631K
0.068	5.0	10.0	19.0	683P106A401K	7.0	13.0	19.0	683P106A631K
0.082	5.5	11.0	19.0	823P106A401K	6.5	12.5	26.5	823P106A631K
0.10	6.0	12.0	19.0	104P106A401K	7.0	13.0	26.5	104P106A631K
0.12	5.5	11.0	26.5	124P106A401K	7.5	13.5	26.5	124P106A631K
0.15	6.0	12.0	26.5	154P106A401K	8.0	14.5	26.5	154P106A631K
0.18	6.5	12.5	26.5	184P106A401K	7.5	13.5	32.0	184P106A631K
0.22	7.0	13.0	26.5	224P106A401K	8.0	15.0	32.0	224P106A631K
0.27	7.5	13.5	26.5	274P106A401K	9.0	16.5	32.0	274P106A631K
0.33	8.0	14.0	26.5	334P106A401K	9.5	17.5	32.0	334P106A631K
0.39	8.0	14.0	32.0	394P106A401K	10.0	19.0	32.0	394P106A631K
0.47	8.5	15.5	32.0	474P106A401K	11.0	21.0	32.0	474P106A631K
0.56	9.0	16.5	32.0	564P106A401K	10.0	19.0	45.0	564P106A631K
0.68	9.5	17.5	32.0	684P106A401K	11.0	21.0	45.0	684P106A631K
0.82	9.5	19.0	32.0	824P106A401K	12.5	22.5	45.0	824P106A631K
1.0	10.5	20.0	32.0	105P106A401K	14.0	25.0	45.0	105P106A631K
1.2	10.0	19.0	45.0	125P106A401K	16.0	27.0	45.0	125P106A631K
1.5	11.5	21.0	45.0	155P106A401K	18.0	30.0	45.0	155P106A631K
1.8	12.5	22.0	45.0	185P106A401K	16.0	27.0	58.0	185P106A631K
2.2	13.5	24.0	45.0	225P106A401K	18.0	30.0	58.0	225P106A631K
2.7	15.0	26.0	45.0	275P106A401K	20.5	33.0	58.0	275P106A631K
3.3	17.0	28.0	45.0	335P106A401K	22.5	36.0	58.0	335P106A631K
3.9	16.5	27.0	58.0	395P106A401K	25.0	40.0	58.0	395P106A631K
4.7	18.5	30.0	58.0	475P106A401K	27.0	44.0	58.0	475P106A631K
5.6	19.5	32.0	58.0	565P106A401K				
6.8	22.0	36.0	58.0	685P106A401K				
8.2	24.0	40.0	58.0	825P106A401K				
10.0	28.0	42.0	58.0	106P106A401K				

*Other Values, Voltages, And Dimensions Are Available On Request



Metallized Polypropylene - Axial Round Wrap & Fill

TYPE: P108 Series

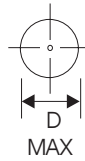
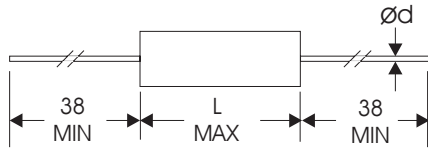

L	11.0	14.0	19.0	26.5	32.0	45.0	58.0
d	0.5	0.6	0.6	0.8	0.8	0.8	1.0

(mm)

CAP. (µF)	160 VDC			250 VDC		
	D	L	Part No.	D	L	Part No.
0.001	5.0	11.0	102P108A161K	5.0	11.0	102P108A251K
0.0012	5.0	11.0	122P108A161K	5.0	11.0	122P108A251K
0.0015	5.0	11.0	152P108A161K	5.0	11.0	152P108A251K
0.0018	5.0	11.0	182P108A161K	5.0	11.0	182P108A251K
0.0022	5.0	11.0	222P108A161K	5.0	11.0	222P108A251K
0.0027	5.0	11.0	272P108A161K	5.0	11.0	272P108A251K
0.0033	5.0	11.0	332P108A161K	5.0	11.0	332P108A251K
0.0039	5.0	11.0	392P108A161K	5.0	11.0	392P108A251K
0.0047	5.0	11.0	472P108A161K	5.0	11.0	472P108A251K
0.0056	5.0	11.0	562P108A161K	5.0	11.0	562P108A251K
0.0068	5.0	11.0	682P108A161K	5.0	11.0	682P108A251K
0.0082	5.0	11.0	822P108A161K	5.0	11.0	822P108A251K
0.01	5.0	11.0	103P108A161K	5.0	11.0	103P108A251K
0.012	5.0	11.0	123P108A161K	5.0	11.0	123P108A251K
0.015	5.0	11.0	153P108A161K	5.0	11.0	153P108A251K
0.018	5.0	11.0	183P108A161K	5.0	11.0	183P108A251K
0.022	5.0	11.0	223P108A161K	5.0	11.0	223P108A251K
0.027	5.0	11.0	273P108A161K	5.0	14.0	273P108A251K
0.033	5.0	11.0	333P108A161K	5.5	14.0	333P108A251K
0.039	5.0	11.0	393P108A161K	6.0	14.0	393P108A251K
0.047	5.5	11.0	473P108A161K	6.5	14.0	473P108A251K
0.056	5.0	14.0	563P108A161K	7.0	14.0	563P108A251K
0.068	5.5	14.0	683P108A161K	7.5	14.0	683P108A251K
0.082	5.5	14.0	823P108A161K	6.0	19.0	823P108A251K
0.10	6.0	14.0	104P108A161K	6.5	19.0	104P108A251K
0.12	6.0	14.0	124P108A161K	7.0	19.0	124P108A251K
0.15	6.5	14.0	154P108A161K	7.5	19.0	154P108A251K
0.18	6.5	19.0	184P108A161K	8.5	19.0	184P108A251K
0.22	7.0	19.0	224P108A161K	9.0	19.0	224P108A251K
0.27	7.0	19.0	274P108A161K	8.5	26.5	274P108A251K
0.33	7.5	19.0	334P108A161K	9.0	26.5	334P108A251K
0.39	8.0	19.0	394P108A161K	9.5	26.5	394P108A251K
0.47	9.0	19.0	474P108A161K	10.0	26.5	474P108A251K
0.56	8.5	26.5	564P108A161K	11.0	26.5	564P108A251K
0.68	9.0	26.5	684P108A161K	12.0	26.5	684P108A251K
0.82	9.5	26.5	824P108A161K	11.0	32.0	824P108A251K
1.0	10.5	26.5	105P108A161K	12.0	32.0	105P108A251K
1.2	11.0	26.5	125P108A161K	13.0	32.0	125P108A251K
1.5	12.5	26.5	155P108A161K	14.5	32.0	155P108A251K
1.8	11.5	32.0	185P108A161K	15.5	32.0	185P108A251K
2.2	12.5	32.0	225P108A161K	17.0	32.0	225P108A251K
2.7	13.5	32.0	275P108A161K	15.5	45.0	275P108A251K
3.3	15.0	32.0	335P108A161K	17.0	45.0	335P108A251K
3.9	16.5	32.0	395P108A161K	18.5	45.0	395P108A251K
4.7	17.5	32.0	475P108A161K	21.0	45.0	475P108A251K
5.6	15.5	45.0	565P108A161K	23.0	45.0	565P108A251K
6.8	17.0	45.0	685P108A161K	25.0	45.0	685P108A251K
8.2	18.5	45.0	825P108A161K	24.0	58.0	825P108A251K
10.0	20.5	45.0	106P108A161K	26.0	58.0	106P108A251K
12.0	23.0	45.0	126P108A161K	28.5	58.0	126P108A251K
15.0	25.5	45.0	156P108A161K	31.5	58.0	156P108A251K
18.0	24.0	58.0	186P108A161K	34.5	58.0	186P108A251K
22.0	25.5	58.0	226P108A161K	38.0	58.0	226P108A251K

*Other Values, Voltages, And Dimensions Are Available On Request



Metallized Polypropylene • Axial Round Wrap & Fill

TYPE: P108 Series

(mm)

CAP. (μF)	400 VDC			630 VDC		
	D	L	Part No.	D	L	Part No.
0.001	5.0	11.0	102P108A401K	5.0	11.0	102P108A631K
0.0012	5.0	11.0	122P108A401K	5.0	11.0	122P108A631K
0.0015	5.0	11.0	152P108A401K	5.0	11.0	152P108A631K
0.0018	5.0	11.0	182P108A401K	5.0	11.0	182P108A631K
0.0022	5.0	11.0	222P108A401K	5.0	11.0	222P108A631K
0.0027	5.0	11.0	272P108A401K	5.0	11.0	272P108A631K
0.0033	5.0	11.0	332P108A401K	5.5	11.0	332P108A631K
0.0039	5.0	11.0	392P108A401K	5.0	14.0	392P108A631K
0.0047	5.0	11.0	472P108A401K	5.0	14.0	472P108A631K
0.0056	5.0	11.0	562P108A401K	5.0	14.0	562P108A631K
0.0068	5.0	11.0	682P108A401K	5.5	14.0	682P108A631K
0.0082	5.0	11.0	822P108A401K	6.0	14.0	822P108A631K
0.01	5.0	11.0	103P108A401K	6.0	14.0	103P108A631K
0.012	5.0	14.0	123P108A401K	6.5	14.0	123P108A631K
0.015	5.5	14.0	153P108A401K	7.0	14.0	153P108A631K
0.018	5.5	14.0	183P108A401K	6.5	19.0	183P108A631K
0.022	6.0	14.0	223P108A401K	7.0	19.0	223P108A631K
0.027	6.5	14.0	273P108A401K	7.5	19.0	273P108A631K
0.033	6.5	14.0	333P108A401K	8.0	19.0	333P108A631K
0.039	7.0	14.0	393P108A401K	8.5	19.0	393P108A631K
0.047	7.5	14.0	473P108A401K	9.0	19.0	473P108A631K
0.056	6.5	19.0	563P108A401K	9.0	19.0	563P108A631K
0.068	7.5	19.0	683P108A401K	9.5	19.0	683P108A631K
0.082	8.0	19.0	823P108A401K	9.0	26.5	823P108A631K
0.10	8.5	19.0	104P108A401K	10.0	26.5	104P108A631K
0.12	8.0	26.5	124P108A401K	10.5	26.5	124P108A631K
0.15	9.0	26.5	154P108A401K	12.0	26.5	154P108A631K
0.18	9.5	26.5	184P108A401K	11.5	32.0	184P108A631K
0.22	10.0	26.5	224P108A401K	12.0	32.0	224P108A631K
0.27	11.0	26.5	274P108A401K	13.0	32.0	274P108A631K
0.33	12.0	26.5	334P108A401K	14.0	32.0	334P108A631K
0.39	11.0	32.0	394P108A401K	15.5	32.0	394P108A631K
0.47	12.0	32.0	474P108A401K	16.5	32.0	474P108A631K
0.56	13.0	32.0	564P108A401K	15.0	45.0	564P108A631K
0.68	14.0	32.0	684P108A401K	16.0	45.0	684P108A631K
0.82	15.0	32.0	824P108A401K	17.5	45.0	824P108A631K
1.0	16.0	32.0	105P108A401K	20.0	45.0	105P108A631K
1.2	15.0	45.0	125P108A401K	22.5	45.0	125P108A631K
1.5	16.5	45.0	155P108A401K	24.5	45.0	155P108A631K
1.8	18.0	45.0	185P108A401K	22.5	58.0	185P108A631K
2.2	19.5	45.0	225P108A401K	25.0	58.0	225P108A631K
2.7	21.5	45.0	275P108A401K	27.5	58.0	275P108A631K
3.3	23.5	45.0	335P108A401K	30.0	58.0	335P108A631K
3.9	23.0	58.0	395P108A401K	32.5	58.0	395P108A631K
4.7	24.5	58.0	475P108A401K	36.0	58.0	475P108A631K
5.6	26.5	58.0	565P108A401K			
6.8	29.0	58.0	685P108A401K			
8.2	32.0	58.0	825P108A401K			
10.0	35.0	58.0	106P108A401K			

*Other Values, Voltages, And Dimensions Are Available On Request