

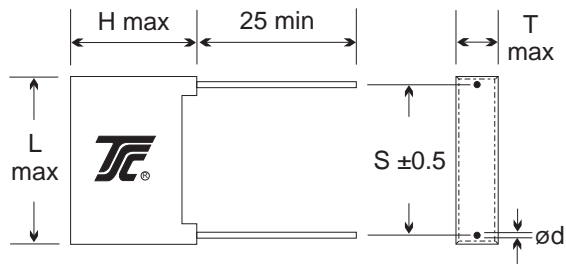

AC Metallized Polypropylene • RadialBox

TYPE: P302 Series



L	10.5	13.0	18.0	26.5	32.0
S	7.5	10.0	15.0	22.5	27.5
d	0.6	0.6	0.8	0.8	0.8

(mm)

CAP. (µF)	250 VAC				300 VAC			
	T	H	L	Part No.	T	H	L	Part No.
0.01	4.0	9.0	10.5	103P302B251K	4.0	9.0	13.0	103P302B301K
0.012	4.0	9.0	10.5	123P302B251K	4.0	9.0	13.0	123P302B301K
0.015	4.0	9.0	10.5	153P302B251K	4.0	9.0	13.0	153P302B301K
0.018	4.0	9.0	10.5	183P302B251K	4.0	9.0	13.0	183P302B301K
0.022	4.0	9.0	10.5	223P302B251K	5.0	11.0	13.0	223P302B301K
0.027	4.0	9.0	13.0	273P302B251K	5.0	11.0	13.0	273P302B301K
0.033	4.0	9.0	13.0	333P302B251K	5.0	11.0	13.0	333P302B301K
0.039	5.0	11.0	13.0	393P302B251K	6.0	12.0	13.0	393P302B301K
0.047	5.0	11.0	13.0	473P302B251K	6.0	12.0	13.0	473P302B301K
0.056	6.0	12.0	13.0	563P302B251K	5.0	11.0	18.0	563P302B301K
0.068	6.0	12.0	13.0	683P302B251K	6.0	12.0	18.0	683P302B301K
0.082	5.0	11.0	18.0	823P302B251K	6.0	12.0	18.0	823P302B301K
0.10	5.0	11.0	18.0	104P302B251K	7.5	13.5	18.0	104P302B301K
0.12	6.0	12.0	18.0	124P302B251K	8.5	15.0	18.0	124P302B301K
0.15	6.0	12.0	18.0	154P302B251K	8.5	15.0	18.0	154P302B301K
0.18	7.5	13.5	18.0	184P302B251K	7.0	16.5	26.5	184P302B301K
0.22	7.5	13.5	18.0	224P302B251K	8.5	17.0	26.5	224P302B301K
0.27	6.0	15.0	26.5	274P302B251K	8.5	17.0	26.5	274P302B301K
0.33	7.0	16.5	26.5	334P302B251K	10.0	19.0	26.5	334P302B301K
0.39	7.0	16.5	26.5	394P302B251K	11.0	20.0	32.0	394P302B301K
0.47	8.5	17.0	26.5	474P302B251K	11.0	20.0	32.0	474P302B301K
0.56	8.5	17.0	26.5	564P302B251K	11.0	20.0	32.0	564P302B301K
0.68	10.0	19.0	26.5	684P302B251K	13.0	22.0	32.0	684P302B301K
0.82	11.0	20.0	32.0	824P302B251K	13.0	22.0	32.0	824P302B301K
1.0	11.0	20.0	32.0	105P302B251K	15.0	25.0	32.0	105P302B301K
1.2	11.0	20.0	32.0	125P302B251K	15.0	25.0	32.0	125P302B301K
1.5	13.0	22.0	32.0	155P302B251K	18.0	30.0	32.0	155P302B301K
1.8	15.0	25.0	32.0	185P302B251K	18.0	30.0	32.0	185P302B301K
2.2	15.0	25.0	32.0	225P302B251K	18.0	30.0	32.0	225P302B301K
2.7	18.0	30.0	32.0	275P302B251K				
3.3	18.0	30.0	32.0	335P302B251K				
3.9	18.0	30.0	32.0	395P302B251K				
4.7	18.0	30.0	32.0	475P302B251K				

CAP. (µF)	480 VAC				600 VAC			
	T	H	L	Part No.	T	H	L	Part No.
0.01	5.0	11.0	18.0	103P302B481K	6.0	12.0	18.0	103P302B601K
0.012	5.0	11.0	18.0	123P302B481K	7.5	13.5	18.0	123P302B601K
0.015	5.0	11.0	18.0	153P302B481K	7.5	13.5	18.0	153P302B601K
0.018	6.0	12.0	18.0	183P302B481K	8.5	15.0	18.0	183P302B601K
0.022	6.0	12.0	18.0	223P302B481K	8.5	15.0	18.0	223P302B601K
0.027	7.5	13.5	18.0	273P302B481K	7.0	16.5	26.5	273P302B601K
0.033	7.5	13.5	18.0	333P302B481K	7.0	16.5	26.5	333P302B601K
0.039	8.5	15.0	18.0	393P302B481K	8.5	17.0	26.5	393P302B601K
0.047	8.5	15.0	18.0	473P302B481K	8.5	17.0	26.5	473P302B601K
0.056	7.0	16.5	26.5	563P302B481K	10.0	19.0	26.5	563P302B601K
0.068	7.0	16.5	26.5	683P302B481K	10.0	19.0	26.5	683P302B601K
0.082	8.5	17.0	26.5	823P302B481K	11.0	20.0	32.0	823P302B601K
0.10	8.5	17.0	26.5	104P302B481K	11.0	20.0	32.0	104P302B601K
0.12	10.0	19.0	26.5	124P302B481K	13.0	22.0	32.0	124P302B601K
0.15	10.0	19.0	26.5	154P302B481K	13.0	22.0	32.0	154P302B601K
0.18	11.0	20.0	32.0	184P302B481K	15.0	25.0	32.0	184P302B601K
0.22	13.0	22.0	32.0	224P302B481K	15.0	25.0	32.0	224P302B601K
0.27	13.0	22.0	32.0	274P302B481K	18.0	30.0	32.0	274P302B601K
0.33	15.0	25.0	32.0	334P302B481K	18.0	30.0	32.0	334P302B601K
0.39	15.0	25.0	32.0	394P302B481K	18.0	30.0	32.0	394P302B601K
0.47	18.0	30.0	32.0	474P302B481K	18.0	30.0	32.0	474P302B601K
0.56	18.0	30.0	32.0	564P302B481K				
0.68	18.0	30.0	32.0	684P302B481K				
0.82	18.0	30.0	32.0	824P302B481K				
1.0	18.0	30.0	32.0	105P302B481K				

*Other Values, Voltages, And Dimensions Are Available On Request



AC Metallized Polypropylene • Radial Epoxy Dipped

TYPE: P304 Series

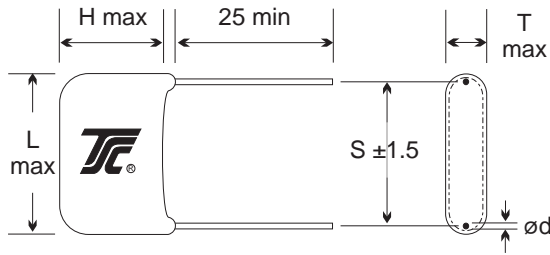

L	10.0	13.0	18.5	26.0	31.0
S	7.5	10.0	15.0	22.5	27.5
d	0.6	0.6	0.8	0.8	0.8

(mm)

CAP. (µF)	250 VAC				300 VAC			
	T	H	L	Part No.	T	H	L	Part No.
0.01	4.0	9.0	10.5	103P304B251K	4.5	9.0	13.0	103P304B301K
0.012	4.0	9.0	10.5	123P304B251K	4.5	9.0	13.0	123P304B301K
0.015	4.0	9.0	10.5	153P304B251K	4.5	9.0	13.0	153P304B301K
0.018	4.0	9.0	10.5	183P304B251K	4.5	9.0	13.0	183P304B301K
0.022	4.0	9.0	10.5	223P304B251K	5.0	9.5	13.0	223P304B301K
0.027	4.0	9.0	13.0	273P304B251K	5.0	10.0	13.0	273P304B301K
0.033	4.0	9.0	13.0	333P304B251K	5.5	11.0	13.0	333P304B301K
0.039	5.0	10.0	13.0	393P304B251K	6.0	12.0	13.0	393P304B301K
0.047	5.5	10.5	13.0	473P304B251K	6.5	12.5	13.0	473P304B301K
0.056	5.5	11.0	13.0	563P304B251K	5.5	11.0	18.5	563P304B301K
0.068	6.0	12.0	13.0	683P304B251K	6.5	12.5	18.5	683P304B301K
0.082	5.0	10.0	18.5	823P304B251K	7.0	13.0	18.5	823P304B301K
0.10	5.5	11.0	18.5	104P304B251K	7.5	14.0	18.5	104P304B301K
0.12	6.0	12.0	18.5	124P304B251K	8.0	15.0	18.5	124P304B301K
0.15	6.5	12.5	18.5	154P304B251K	8.5	16.0	18.5	154P304B301K
0.18	7.0	13.0	18.5	184P304B251K	8.0	14.0	26.0	184P304B301K
0.22	7.5	14.0	18.5	224P304B251K	8.5	16.0	26.0	224P304B301K
0.27	6.5	12.5	26.0	274P304B251K	9.0	16.5	26.0	274P304B301K
0.33	7.5	14.0	26.0	334P304B251K	9.5	18.0	26.0	334P304B301K
0.39	8.0	14.5	26.0	394P304B251K	9.5	18.0	31.0	394P304B301K
0.47	8.5	15.0	26.0	474P304B251K	10.0	19.0	31.0	474P304B301K
0.56	9.0	16.5	26.0	564P304B251K	11.0	20.0	31.0	564P304B301K
0.68	9.5	18.0	26.0	684P304B251K	12.0	22.0	31.0	684P304B301K
0.82	9.5	18.0	31.0	824P304B251K	13.0	24.0	31.0	824P304B301K
1.0	10.0	19.0	31.0	105P304B251K	14.0	26.0	31.0	105P304B301K
1.2	11.0	21.0	31.0	125P304B251K	15.0	27.0	31.0	125P304B301K
1.5	12.5	23.0	31.0	155P304B251K	17.0	30.0	31.0	155P304B301K
1.8	13.0	24.0	31.0	185P304B251K	19.0	32.0	31.0	185P304B301K
2.2	14.0	26.0	31.0	225P304B251K	20.5	34.0	31.0	225P304B301K
2.7	15.5	28.0	31.0	275P304B251K				
3.3	17.5	30.0	31.0	335P304B251K				
3.9	19.0	33.0	31.0	395P304B251K				
4.7	22.0	36.0	31.0	475P304B251K				

CAP. (µF)	480 VAC				600 VAC			
	T	H	L	Part No.	T	H	L	Part No.
0.01	4.5	9.0	18.5	103P304B481K	7.0	13.0	18.5	103P304B601K
0.012	5.0	10.0	18.5	123P304B481K	7.5	13.5	18.5	123P304B601K
0.015	5.0	11.0	18.5	153P304B481K	8.0	14.0	18.5	153P304B601K
0.018	6.0	12.0	18.5	183P304B481K	8.5	15.0	18.5	183P304B601K
0.022	6.5	12.5	18.5	223P304B481K	9.0	16.5	18.5	223P304B601K
0.027	7.5	13.5	18.5	273P304B481K	7.5	13.5	26.0	273P304B601K
0.033	8.0	14.0	18.5	333P304B481K	8.0	14.0	26.0	333P304B601K
0.039	8.5	15.5	18.5	393P304B481K	8.5	15.5	26.0	393P304B601K
0.047	9.0	16.5	18.5	473P304B481K	9.0	16.5	26.0	473P304B601K
0.056	7.5	13.5	26.0	563P304B481K	9.5	18.0	26.0	563P304B601K
0.068	8.0	14.0	26.0	683P304B481K	10.0	19.0	26.0	683P304B601K
0.082	8.5	15.5	26.0	823P304B481K	9.5	18.0	31.0	823P304B601K
0.10	9.0	16.5	26.0	104P304B481K	10.5	20.0	31.0	104P304B601K
0.12	9.5	18.0	26.0	124P304B481K	11.5	22.0	31.0	124P304B601K
0.15	10.0	19.0	26.0	154P304B481K	13.0	24.0	31.0	154P304B601K
0.18	10.0	19.0	31.0	184P304B481K	14.0	25.0	31.0	184P304B601K
0.22	11.5	20.5	31.0	224P304B481K	15.0	27.0	31.0	224P304B601K
0.27	12.5	22.0	31.0	274P304B481K	16.5	29.0	31.0	274P304B601K
0.33	13.5	24.0	31.0	334P304B481K	19.0	32.0	31.0	334P304B601K
0.39	14.5	26.0	31.0	394P304B481K	21.5	34.0	31.0	394P304B601K
0.47	15.5	28.0	31.0	474P304B481K	22.0	36.0	31.0	474P304B601K
0.56	16.0	29.0	31.0	564P304B481K				
0.68	18.0	31.0	31.0	684P304B481K				
0.82	20.5	34.0	31.0	824P304B481K				
1.0	22.0	36.0	31.0	105P304B481K				

*Other Values, Voltages, And Dimensions Are Available On Request



AC Metallized Polypropylene - Axial Oval Wrap & Fill

TYPE: P306 Series

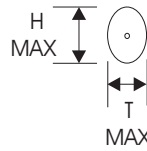
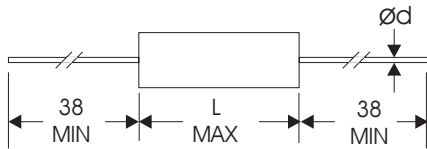

L	11.0	14.0	19.0	26.5	32.0	45.0	58.0
d	0.6	0.6	0.6	0.8	0.8	0.8	1.0

(mm)

CAP. (µF)	250 VAC				Part No.	300 VAC			
	T	H	L	Part No.		T	H	L	Part No.
0.01	3.5	6.0	11.0	103P306B251K	3.5	6.0	14.0	103P306B301K	
0.012	3.5	6.0	11.0	123P306B251K	3.5	6.0	14.0	123P306B301K	
0.015	3.5	6.0	11.0	153P306B251K	3.5	6.0	14.0	153P306B301K	
0.018	3.5	6.0	11.0	183P306B251K	3.5	6.5	14.0	183P306B301K	
0.022	3.5	6.0	11.0	223P306B251K	4.0	7.0	14.0	223P306B301K	
0.027	3.5	6.0	14.0	273P306B251K	4.0	7.5	14.0	273P306B301K	
0.033	3.5	6.5	14.0	333P306B251K	4.5	8.0	14.0	333P306B301K	
0.039	4.0	7.0	14.0	393P306B251K	4.5	9.0	14.0	393P306B301K	
0.047	4.5	8.0	14.0	473P306B251K	5.0	9.5	14.0	473P306B301K	
0.056	4.5	8.5	14.0	563P306B251K	4.5	9.0	19.0	563P306B301K	
0.068	5.0	9.5	14.0	683P306B251K	5.0	10.0	19.0	683P306B301K	
0.082	4.0	7.5	19.0	823P306B251K	5.5	11.0	19.0	823P306B301K	
0.10	4.5	8.5	19.0	104P306B251K	6.0	12.0	19.0	104P306B301K	
0.12	5.0	9.0	19.0	124P306B251K	5.5	11.0	26.5	124P306B301K	
0.15	5.0	10.0	19.0	154P306B251K	6.0	12.0	26.5	154P306B301K	
0.18	5.5	11.0	19.0	184P306B251K	6.5	12.5	26.5	184P306B301K	
0.22	6.0	12.0	19.0	224P306B251K	7.0	13.0	26.5	224P306B301K	
0.27	5.5	11.0	26.5	274P306B251K	7.5	13.5	26.5	274P306B301K	
0.33	6.0	12.0	26.5	334P306B251K	8.0	14.0	26.5	334P306B301K	
0.39	6.5	12.5	26.5	394P306B251K	8.0	14.0	32.0	394P306B301K	
0.47	7.0	13.0	26.5	474P306B251K	8.5	15.5	32.0	474P306B301K	
0.56	7.5	13.5	26.5	564P306B251K	9.0	16.5	32.0	564P306B301K	
0.68	8.0	15.0	26.5	684P306B251K	9.5	17.5	32.0	684P306B301K	
0.82	7.5	13.5	32.0	824P306B251K	9.5	19.0	32.0	824P306B301K	
1.0	8.5	15.0	32.0	105P306B251K	10.5	20.0	32.0	105P306B301K	
1.2	9.0	16.5	32.0	125P306B251K	10.0	19.0	45.0	125P306B301K	
1.5	9.5	18.0	32.0	155P306B251K	11.5	21.0	45.0	155P306B301K	
1.8	10.0	19.0	32.0	185P306B251K	12.5	22.0	45.0	185P306B301K	
2.2	11.5	21.5	32.0	225P306B251K	13.5	24.0	45.0	225P306B301K	
2.7	10.5	20.0	45.0	275P306B251K	15.0	26.0	45.0	275P306B301K	
3.3	12.0	22.0	45.0	335P306B251K	17.0	28.0	45.0	335P306B301K	
3.9	13.0	24.0	45.0	395P306B251K	16.5	27.0	58.0	395P306B301K	
4.7	14.5	26.0	45.0	475P306B251K	18.5	30.0	58.0	475P306B301K	
5.6	16.0	27.0	45.0	565P306B251K	19.5	32.0	58.0	565P306B301K	
6.8	18.5	30.0	45.0	685P306B251K	22.0	36.0	58.0	685P306B301K	
8.2	17.5	28.0	58.0	825P306B251K	24.0	40.0	58.0	825P306B301K	
10.0	19.5	32.0	58.0	106P306B251K	28.0	42.0	58.0	106P306B301K	
12.0	21.5	36.0	58.0	126P306B251K					
15.0	24.0	38.0	58.0	156P306B251K					
18.0	26.0	40.0	58.0	186P306B251K					
22.0	30.0	44.0	58.0	226P306B251K					

CAP. (µF)	480 VAC				Part No.	600 VAC			
	T	H	L	Part No.		T	H	L	Part No.
0.01	3.5	6.5	19.0	103P306B481K	5.5	10.0	19.0	103P306B601K	
0.012	4.0	7.5	19.0	123P306B481K	6.0	11.0	19.0	123P306B601K	
0.015	4.5	8.0	19.0	153P306B481K	6.5	12.0	19.0	153P306B601K	
0.018	5.0	9.0	19.0	183P306B481K	5.0	10.0	26.5	183P306B601K	
0.022	5.5	10.0	19.0	223P306B481K	5.5	11.0	26.5	223P306B601K	
0.027	6.0	11.0	19.0	273P306B481K	6.0	12.0	26.5	273P306B601K	
0.033	6.5	12.0	19.0	333P306B481K	6.5	12.5	26.5	333P306B601K	
0.039	5.0	10.0	26.5	393P306B481K	7.0	13.0	26.5	393P306B601K	
0.047	5.5	10.5	26.5	473P306B481K	7.5	13.5	26.5	473P306B601K	
0.056	5.5	11.0	26.5	563P306B481K	8.0	15.0	26.5	563P306B601K	
0.068	6.0	12.0	26.5	683P306B481K	9.0	16.0	26.5	683P306B601K	
0.082	6.5	12.5	26.5	823P306B481K	8.0	15.0	32.0	823P306B601K	
0.10	7.5	13.5	26.5	104P306B481K	9.0	16.0	32.0	104P306B601K	
0.12	7.0	13.0	32.0	124P306B481K	9.5	17.5	32.0	124P306B601K	
0.15	8.0	14.5	32.0	154P306B481K	10.0	19.0	32.0	154P306B601K	
0.18	8.5	16.0	32.0	184P306B481K	9.5	18.0	45.0	184P306B601K	
0.22	9.0	17.0	32.0	224P306B481K	10.5	20.0	45.0	224P306B601K	
0.27	9.5	18.0	32.0	274P306B481K	11.0	21.0	45.0	274P306B601K	
0.33	10.5	20.0	32.0	334P306B481K	13.0	23.0	45.0	334P306B601K	
0.39	9.5	18.0	45.0	394P306B481K	14.0	25.0	45.0	394P306B601K	
0.47	10.0	19.0	45.0	474P306B481K	15.5	27.0	45.0	474P306B601K	
0.56	11.0	20.0	45.0	564P306B481K	17.5	30.0	45.0	564P306B601K	
0.68	12.0	22.0	45.0	684P306B481K	19.0	32.0	45.0	684P306B601K	
0.82	13.0	24.0	45.0	824P306B481K	21.5	35.0	45.0	824P306B601K	
1.0	15.0	26.0	45.0	105P306B481K	23.0	38.0	45.0	105P306B601K	
1.2	16.0	27.0	45.0	125P306B481K					
1.5	18.5	30.0	45.0	155P306B481K					
1.8	20.5	33.0	45.0	185P306B481K					
2.2	23.0	36.0	45.0	225P306B481K					

*Other Values, Voltages, And Dimensions Are Available On Request



AC Metallized Polypropylene - Axial Round Wrap & Fill

TYPE: P308 Series

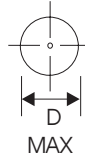
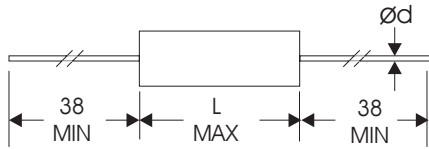

L	11.0	14.0	19.0	26.5	32.0	45.0	58.0
d	0.6	0.6	0.6	0.8	0.8	0.8	1.0

(mm)

CAP. (µF)	250 VAC			300 VAC		
	D	L	Part No.	D	L	Part No.
0.01	5.0	11.0	103P308B251K	5.0	14.0	103P308B301K
0.012	5.0	11.0	123P308B251K	5.0	14.0	123P308B301K
0.015	5.0	11.0	153P308B251K	5.5	14.0	153P308B301K
0.018	5.0	11.0	183P308B251K	5.5	14.0	183P308B301K
0.022	5.0	11.0	223P308B251K	6.0	14.0	223P308B301K
0.027	5.0	14.0	273P308B251K	6.5	14.0	273P308B301K
0.033	5.5	14.0	333P308B251K	6.5	14.0	333P308B301K
0.039	6.0	14.0	393P308B251K	7.0	14.0	393P308B301K
0.047	6.5	14.0	473P308B251K	7.5	14.0	473P308B301K
0.056	7.0	14.0	563P308B251K	6.5	19.0	563P308B301K
0.068	7.5	14.0	683P308B251K	7.5	19.0	683P308B301K
0.082	6.0	19.0	823P308B251K	8.0	19.0	823P308B301K
0.10	6.5	19.0	104P308B251K	8.5	19.0	104P308B301K
0.12	7.0	19.0	124P308B251K	8.5	26.5	124P308B301K
0.15	7.5	19.0	154P308B251K	9.0	26.5	154P308B301K
0.18	8.5	19.0	184P308B251K	9.5	26.5	184P308B301K
0.22	9.0	19.0	224P308B251K	10.0	26.5	224P308B301K
0.27	8.5	26.5	274P308B251K	11.0	26.5	274P308B301K
0.33	9.0	26.5	334P308B251K	12.0	26.5	334P308B301K
0.39	9.5	26.5	394P308B251K	11.0	32.0	394P308B301K
0.47	10.0	26.5	474P308B251K	12.0	32.0	474P308B301K
0.56	11.0	26.5	564P308B251K	13.0	32.0	564P308B301K
0.68	12.0	26.5	684P308B251K	14.0	32.0	684P308B301K
0.82	11.0	32.0	824P308B251K	15.0	32.0	824P308B301K
1.0	12.0	32.0	105P308B251K	16.0	32.0	105P308B301K
1.2	13.0	32.0	125P308B251K	15.0	45.0	125P308B301K
1.5	14.5	32.0	155P308B251K	16.5	45.0	155P308B301K
1.8	15.5	32.0	185P308B251K	18.0	45.0	185P308B301K
2.2	17.0	32.0	225P308B251K	19.5	45.0	225P308B301K
2.7	15.5	45.0	275P308B251K	21.5	45.0	275P308B301K
3.3	17.0	45.0	335P308B251K	23.5	45.0	335P308B301K
3.9	18.5	45.0	395P308B251K	23.5	58.0	395P308B301K
4.7	21.0	45.0	475P308B251K	24.5	58.0	475P308B301K
5.6	23.0	45.0	565P308B251K	26.5	58.0	565P308B301K
6.8	25.0	45.0	685P308B251K	29.0	58.0	685P308B301K
8.2	24.0	58.0	825P308B251K	32.0	58.0	825P308B301K
10.0	26.0	58.0	106P308B251K	35.0	58.0	106P308B301K
12.0	28.5	58.0	126P308B251K			
15.0	31.5	58.0	156P308B251K			
18.0	34.5	58.0	186P308B251K			
22.0	38.0	58.0	226P308B251K			

CAP. (µF)	480 VAC			600 VAC		
	D	L	Part No.	D	L	Part No.
0.01	5.5	19.0	103P308B481K	8.0	19.0	103P308B601K
0.012	6.0	19.0	123P308B481K	8.5	19.0	123P308B601K
0.015	6.5	19.0	153P308B481K	9.0	19.0	153P308B601K
0.018	7.0	19.0	183P308B481K	7.5	26.5	183P308B601K
0.022	7.5	19.0	223P308B481K	8.0	26.5	223P308B601K
0.027	8.5	19.0	273P308B481K	8.5	26.5	273P308B601K
0.033	9.0	19.0	333P308B481K	9.5	26.5	333P308B601K
0.039	7.5	26.5	393P308B481K	10.0	26.5	393P308B601K
0.047	8.0	26.5	473P308B481K	10.5	26.5	473P308B601K
0.056	8.5	26.5	563P308B481K	12.0	26.5	563P308B601K
0.068	9.0	26.5	683P308B481K	12.5	26.5	683P308B601K
0.082	9.5	26.5	823P308B481K	12.0	32.0	823P308B601K
0.10	10.5	26.5	104P308B481K	13.0	32.0	104P308B601K
0.12	10.0	32.0	124P308B481K	14.0	32.0	124P308B601K
0.15	11.5	32.0	154P308B481K	15.0	32.0	154P308B601K
0.18	12.5	32.0	184P308B481K	14.5	45.0	184P308B601K
0.22	13.5	32.0	224P308B481K	16.0	45.0	224P308B601K
0.27	14.5	32.0	274P308B481K	16.5	45.0	274P308B601K
0.33	16.0	32.0	334P308B481K	18.0	45.0	334P308B601K
0.39	14.5	45.0	394P308B481K	19.5	45.0	394P308B601K
0.47	15.5	45.0	474P308B481K	22.0	45.0	474P308B601K
0.56	16.5	45.0	564P308B481K	24.0	45.0	564P308B601K
0.68	17.5	45.0	684P308B481K	26.0	45.0	684P308B601K
0.82	19.0	45.0	824P308B481K	28.5	45.0	824P308B601K
1.0	21.0	45.0	105P308B481K	31.0	45.0	105P308B601K
1.2	22.5	45.0	125P308B481K			
1.5	25.0	45.0	155P308B481K			
1.8	27.0	45.0	185P308B481K			
2.2	30.0	45.0	225P308B481K			

*Other Values, Voltages, And Dimensions Are Available On Request