

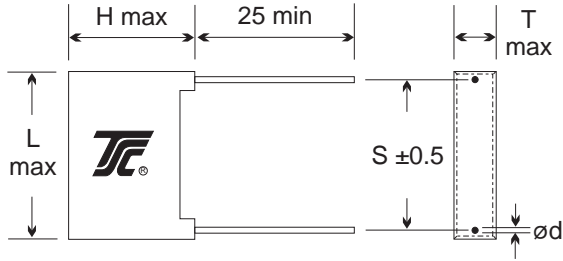

Series Wound Metallized Polypropylene Radial Box

TYPE: P402 Series



L	18.0	26.5	32.0
S	15.0	22.5	27.5
d	0.8	0.8	0.8

(mm)

CAP. (µF)	630VDC / 400VAC				1000VDC / 500VAC			
	T	H	L	Part No.	T	H	L	Part No.
0.001	5.0	11.0	18.0	102P402B401K	5.0	11.0	18.0	102P402B501K
0.0012	5.0	11.0	18.0	122P402B401K	5.0	11.0	18.0	122P402B501K
0.0015	5.0	11.0	18.0	152P402B401K	5.0	11.0	18.0	152P402B501K
0.0018	5.0	11.0	18.0	182P402B401K	5.0	11.0	18.0	182P402B501K
0.0022	5.0	11.0	18.0	222P402B401K	5.0	11.0	18.0	222P402B501K
0.0027	5.0	11.0	18.0	272P402B401K	5.0	11.0	18.0	272P402B501K
0.0033	5.0	11.0	18.0	332P402B401K	5.0	11.0	18.0	332P402B501K
0.0039	5.0	11.0	18.0	392P402B401K	5.0	11.0	18.0	392P402B501K
0.0047	5.0	11.0	18.0	472P402B401K	6.0	12.0	18.0	472P402B501K
0.0056	5.0	11.0	18.0	562P402B401K	6.0	12.0	18.0	562P402B501K
0.0068	5.0	11.0	18.0	682P402B401K	6.0	12.0	18.0	682P402B501K
0.0082	6.0	12.0	18.0	822P402B401K	6.0	12.0	18.0	822P402B501K
0.01	6.0	12.0	18.0	103P402B401K	7.5	13.5	18.0	103P402B501K
0.012	6.0	12.0	18.0	123P402B401K	7.5	13.5	18.0	123P402B501K
0.015	7.5	13.5	18.0	153P402B401K	8.5	15.0	18.0	153P402B501K
0.018	7.5	13.5	18.0	183P402B401K	7.0	16.5	26.5	183P402B501K
0.022	8.5	15.0	18.0	223P402B401K	7.0	16.5	26.5	223P402B501K
0.027	6.0	15.0	26.5	273P402B401K	8.5	17.0	26.5	273P402B501K
0.033	7.0	16.5	26.5	333P402B401K	8.5	17.0	26.5	333P402B501K
0.039	7.0	16.5	26.5	393P402B401K	10.0	19.0	26.5	393P402B501K
0.047	8.5	17.0	26.5	473P402B401K	10.0	19.0	26.5	473P402B501K
0.056	8.5	17.0	26.5	563P402B401K	11.0	20.0	32.0	563P402B501K
0.068	10.0	19.0	26.5	683P402B401K	11.0	20.0	32.0	683P402B501K
0.082	11.0	20.0	32.0	823P402B401K	13.0	22.0	32.0	823P402B501K
0.10	11.0	20.0	32.0	104P402B401K	13.0	22.0	32.0	104P402B501K
0.12	11.0	20.0	32.0	124P402B401K	15.0	25.0	32.0	124P402B501K
0.15	13.0	22.0	32.0	154P402B401K	15.0	25.0	32.0	154P402B501K
0.18	15.0	25.0	32.0	184P402B401K	18.0	30.0	32.0	184P402B501K
0.22	15.0	25.0	32.0	224P402B401K	18.0	30.0	32.0	224P402B501K
0.27	18.0	30.0	32.0	274P402B401K				
0.33	18.0	30.0	32.0	334P402B401K				
0.39	18.0	30.0	32.0	394P402B401K				
0.47	18.0	30.0	32.0	474P402B401K				

CAP. (µF)	1600VDC / 600VAC				2000VDC / 650 VAC			
	T	H	L	Part No.	T	H	L	Part No.
0.001	5.0	11.0	18.0	102P402B601K	6.0	12.0	18.0	102P402B651K
0.0012	5.0	11.0	18.0	122P402B601K	6.0	12.0	18.0	122P402B651K
0.0015	6.0	12.0	18.0	152P402B601K	6.0	12.0	18.0	152P402B651K
0.0018	6.0	12.0	18.0	182P402B601K	7.5	13.5	18.0	182P402B651K
0.0022	6.0	12.0	18.0	222P402B601K	7.5	13.5	18.0	222P402B651K
0.0027	6.0	12.0	18.0	272P402B601K	7.5	13.5	18.0	272P402B651K
0.0033	7.5	13.5	18.0	332P402B601K	8.5	15.0	18.0	332P402B651K
0.0039	7.5	13.5	18.0	392P402B601K	6.0	15.0	26.5	392P402B651K
0.0047	7.5	13.5	18.0	472P402B601K	7.0	16.5	26.5	472P402B651K
0.0056	8.5	15.0	18.0	562P402B601K	7.0	16.5	26.5	562P402B651K
0.0068	8.5	15.0	18.0	682P402B601K	7.0	16.5	26.5	682P402B651K
0.0082	7.0	16.5	26.5	822P402B601K	8.5	17.0	26.5	822P402B651K
0.01	7.0	16.5	26.5	103P402B601K	8.5	17.0	26.5	103P402B651K
0.012	7.0	16.5	26.5	123P402B601K	10.0	19.0	26.5	123P402B651K
0.015	8.5	17.0	26.5	153P402B601K	10.0	19.0	26.5	153P402B651K
0.018	8.5	17.0	26.5	183P402B601K	11.0	20.0	32.0	183P402B651K
0.022	10.0	19.0	26.5	223P402B601K	11.0	20.0	32.0	223P402B651K
0.027	11.0	20.0	32.0	273P402B601K	13.0	22.0	32.0	273P402B651K
0.033	11.0	20.0	32.0	333P402B601K	15.0	25.0	32.0	333P402B651K
0.039	13.0	22.0	32.0	393P402B601K	15.0	25.0	32.0	393P402B651K
0.047	13.0	22.0	32.0	473P402B601K	18.0	30.0	32.0	473P402B651K
0.056	15.0	25.0	32.0	563P402B601K				
0.068	15.0	25.0	32.0	683P402B601K				
0.082	18.0	30.0	32.0	823P402B601K				
0.10	18.0	30.0	32.0	104P402B601K				

*Other Values, Voltages, And Dimensions Are Available On Request



Series Wound Metallized Polypropylene Radial Epoxy Dipped

TYPE: P404 Series

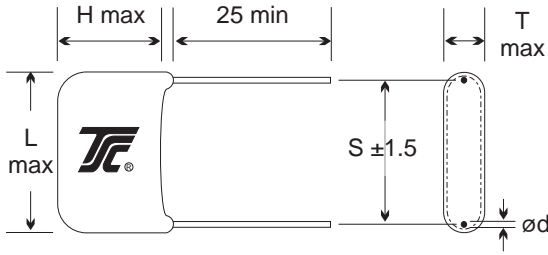

L	18.0	26.0	31.0	44.0
S	15.0	22.5	27.5	38.0
d	0.8	0.8	0.8	0.8

(mm)

CAP. (µF)	630VDC / 400VAC				1000VDC / 500VAC			
	T	H	L	Part No.	T	H	L	Part No.
0.001	4.5	9.0	18.5	102P404B401K	4.5	9.0	18.5	102P404B501K
0.0012	4.5	9.0	18.5	122P404B401K	4.5	9.0	18.5	122P404B501K
0.0015	4.5	9.0	18.5	152P404B401K	4.5	9.0	18.5	152P404B501K
0.0018	4.5	9.0	18.5	182P404B401K	4.5	9.5	18.5	182P404B501K
0.0022	4.5	9.0	18.5	222P404B401K	5.0	10.0	18.5	222P404B501K
0.0027	4.5	9.0	18.5	272P404B401K	5.0	10.5	18.5	272P404B501K
0.0033	4.5	9.0	18.5	332P404B401K	5.5	11.0	18.5	332P404B501K
0.0039	5.0	10.0	18.5	392P404B401K	6.0	11.5	18.5	392P404B501K
0.0047	5.0	10.5	18.5	472P404B401K	6.0	12.0	18.5	472P404B501K
0.0056	5.5	10.5	18.5	562P404B401K	6.5	12.0	18.5	562P404B501K
0.0068	5.5	11.0	18.5	682P404B401K	6.5	12.5	18.5	682P404B501K
0.0082	6.0	12.0	18.5	822P404B401K	7.0	13.0	18.5	822P404B501K
0.01	6.0	12.5	18.5	103P404B401K	7.5	13.5	18.5	103P404B501K
0.012	6.5	12.5	18.5	123P404B401K	8.0	14.0	18.5	123P404B501K
0.015	7.0	13.0	18.5	153P404B401K	8.5	15.5	18.5	153P404B501K
0.018	7.5	13.5	18.5	183P404B401K	7.5	13.5	26.0	183P404B501K
0.022	8.0	14.5	18.5	223P404B401K	8.0	14.5	26.0	223P404B501K
0.027	7.0	13.0	26.0	273P404B401K	8.5	16.0	26.0	273P404B501K
0.033	7.5	14.0	26.0	333P404B401K	9.0	16.5	26.0	333P404B501K
0.039	8.0	15.0	26.0	393P404B401K	9.5	18.0	26.0	393P404B501K
0.047	8.5	16.0	26.0	473P404B401K	10.0	19.0	26.0	473P404B501K
0.056	9.0	16.5	26.0	563P404B401K	10.0	19.0	31.0	563P404B501K
0.068	9.5	17.5	26.0	683P404B401K	10.5	20.0	31.0	683P404B501K
0.082	9.5	17.5	31.0	823P404B401K	12.0	21.5	31.0	823P404B501K
0.10	10.0	19.0	31.0	104P404B401K	12.5	23.0	31.0	104P404B501K
0.12	11.0	20.5	31.0	124P404B401K	13.5	25.0	31.0	124P404B501K
0.15	12.5	23.0	31.0	154P404B401K	15.0	27.0	31.0	154P404B501K
0.18	13.0	24.0	31.0	184P404B401K	16.0	29.0	31.0	184P404B501K
0.22	14.0	26.0	31.0	224P404B401K	18.0	32.0	31.0	224P404B501K
0.27	15.5	28.0	31.0	274P404B401K				
0.33	16.5	30.0	31.0	334P404B401K				
0.39	18.0	32.0	31.0	394P404B401K				
0.47	20.0	34.0	31.0	474P404B401K				

CAP. (µF)	1600VDC / 600VAC				2000VDC / 650 VAC			
	T	H	L	Part No.	T	H	L	Part No.
0.001	5.0	9.5	18.5	102P404B601K	6.0	11.0	18.5	102P404B651K
0.0012	5.5	10.0	18.5	122P404B601K	6.5	12.0	18.5	122P404B651K
0.0015	5.5	10.5	18.5	152P404B601K	6.5	12.5	18.5	152P404B651K
0.0018	6.0	11.0	18.5	182P404B601K	7.0	13.0	18.5	182P404B651K
0.0022	6.0	12.0	18.5	222P404B601K	7.5	13.0	18.5	222P404B651K
0.0027	6.5	12.5	18.5	272P404B601K	7.5	13.5	18.5	272P404B651K
0.0033	7.0	13.0	18.5	332P404B601K	8.0	14.0	18.5	332P404B651K
0.0039	7.0	13.5	18.5	392P404B601K	7.0	13.0	26.0	392P404B651K
0.0047	7.5	14.0	18.5	472P404B601K	7.5	13.5	26.0	472P404B651K
0.0056	8.0	15.0	18.5	562P404B601K	8.0	14.0	26.0	562P404B651K
0.0068	8.5	16.0	18.5	682P404B601K	8.5	15.5	26.0	682P404B651K
0.0082	7.0	13.0	26.0	822P404B601K	8.5	16.0	26.0	822P404B651K
0.01	8.0	14.5	26.0	103P404B601K	9.0	16.5	26.0	103P404B651K
0.012	8.5	15.5	26.0	123P404B601K	9.5	18.0	26.0	123P404B651K
0.015	9.0	17.0	26.0	153P404B601K	10.0	19.0	26.0	153P404B651K
0.018	9.5	18.0	26.0	183P404B601K	10.0	19.0	31.0	183P404B651K
0.022	10.0	19.0	26.0	223P404B601K	10.5	20.0	31.0	223P404B651K
0.027	10.0	19.0	31.0	273P404B601K	12.0	22.0	31.0	273P404B651K
0.033	10.5	20.0	31.0	333P404B601K	13.0	24.0	31.0	333P404B651K
0.039	11.5	21.0	31.0	393P404B601K	13.5	26.0	31.0	393P404B651K
0.047	12.0	22.0	31.0	473P404B601K	14.5	27.0	31.0	473P404B651K
0.056	13.0	24.0	31.0	563P404B601K	14.0	26.0	44.0	563P404B651K
0.068	14.5	27.0	31.0	683P404B601K	15.0	28.0	44.0	683P404B651K
0.082	15.0	28.0	31.0	823P404B601K	16.5	30.0	44.0	823P404B651K
0.10	17.0	30.0	31.0	104P404B601K	18.0	34.0	44.0	104P404B651K
0.12	14.5	27.0	44.0	124P404B601K				
0.15	16.5	30.0	44.0	154P404B601K				
0.18	17.5	33.0	44.0	184P404B601K				
0.22	19.5	36.0	44.0	224P404B601K				

*Other Values, Voltages, And Dimensions Are Available On Request



Series Wound Metallized Polypropylene Axial Oval Wrap & Fill

TYPE: P406 Series

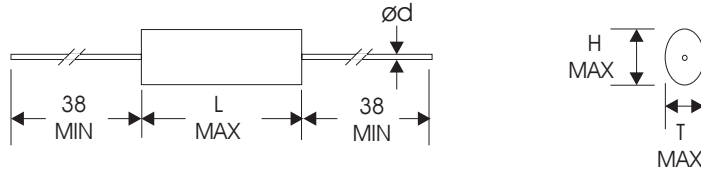

L	19.0	26.5	32.0	45.0
d	0.6	0.8	0.8	1.0

(mm)

CAP. (µF)	630VDC / 400VAC				1000VDC / 500VAC			
	T	H	L	Part No.	T	H	L	Part No.
0.001	4.0	7.0	19.0	102P406B401K	4.0	7.0	19.0	102P406B501K
0.0012	4.0	7.0	19.0	122P406B401K	4.0	7.0	19.0	122P406B501K
0.0015	4.0	7.0	19.0	152P406B401K	4.0	7.0	19.0	152P406B501K
0.0018	4.0	7.0	19.0	182P406B401K	4.0	7.0	19.0	182P406B501K
0.0022	4.0	7.0	19.0	222P406B401K	4.0	7.5	19.0	222P406B501K
0.0027	4.0	7.0	19.0	272P406B401K	4.0	7.5	19.0	272P406B501K
0.0033	4.0	7.0	19.0	332P406B401K	4.5	8.0	19.0	332P406B501K
0.0039	4.0	7.5	19.0	392P406B401K	4.5	8.5	19.0	392P406B501K
0.0047	4.0	7.5	19.0	472P406B401K	5.0	9.0	19.0	472P406B501K
0.0056	4.5	8.0	19.0	562P406B401K	5.0	9.5	19.0	562P406B501K
0.0068	4.5	8.5	19.0	682P406B401K	5.5	10.0	19.0	682P406B501K
0.0082	5.0	9.0	19.0	822P406B401K	5.5	11.0	19.0	822P406B501K
0.01	5.0	9.5	19.0	103P406B401K	6.0	11.5	19.0	103P406B501K
0.012	5.0	10.0	19.0	123P406B401K	6.0	12.0	19.0	123P406B501K
0.015	5.5	11.0	19.0	153P406B401K	6.5	12.5	19.0	153P406B501K
0.018	6.0	11.5	19.0	183P406B401K	6.0	11.5	26.5	183P406B501K
0.022	6.0	12.0	19.0	223P406B401K	6.0	12.0	26.5	223P406B501K
0.027	5.5	11.0	26.5	273P406B401K	7.0	13.0	26.5	273P406B501K
0.033	6.0	12.0	26.5	333P406B401K	7.5	13.5	26.5	333P406B501K
0.039	6.0	12.5	26.5	393P406B401K	8.0	14.0	26.5	393P406B501K
0.047	6.5	12.5	26.5	473P406B401K	8.5	15.5	26.5	473P406B501K
0.056	7.5	13.5	26.5	563P406B401K	8.0	15.0	32.0	563P406B501K
0.068	8.0	14.5	26.5	683P406B401K	9.0	16.5	32.0	683P406B501K
0.082	8.0	14.5	32.0	823P406B401K	9.5	18.0	32.0	823P406B501K
0.10	8.5	15.5	32.0	104P406B401K	9.5	19.0	32.0	104P406B501K
0.12	9.0	17.0	32.0	124P406B401K	9.5	18.0	45.0	124P406B501K
0.15	9.5	18.5	32.0	154P406B401K	10.5	20.0	45.0	154P406B501K
0.18	10.0	20.0	32.0	184P406B401K	12.0	21.0	45.0	184P406B501K
0.22	11.5	21.5	32.0	224P406B401K	13.0	24.0	45.0	224P406B501K
0.27	9.5	19.0	45.0	274P406B401K	14.5	26.0	45.0	274P406B501K
0.33	10.5	21.0	45.0	334P406B401K	16.5	28.0	45.0	334P406B501K
0.39	12.5	22.5	45.0	394P406B401K	18.0	30.0	45.0	394P406B501K
0.47	13.0	24.0	45.0	474P406B401K	20.0	34.0	45.0	474P406B501K
0.56	14.5	25.5	45.0	564P406B401K	22.0	36.0	45.0	564P406B501K
0.68	16.0	27.0	45.0	684P406B401K	25.0	40.0	45.0	684P406B501K
0.82	18.0	30.0	45.0	824P406B401K				
1.0	21.0	35.0	45.0	105P406B401K				

CAP. (µF)	1600VDC / 600VAC				2000VDC / 650 VAC			
	T	H	L	Part No.	T	H	L	Part No.
0.001	4.5	8.0	19.0	102P406B601K	5.0	9.5	19.0	102P406B651K
0.0012	4.5	9.0	19.0	122P406B601K	5.0	10.0	19.0	122P406B651K
0.0015	5.0	9.0	19.0	152P406B601K	5.5	10.0	19.0	152P406B651K
0.0018	5.0	9.5	19.0	182P406B601K	5.5	10.5	19.0	182P406B651K
0.0022	5.0	10.0	19.0	222P406B601K	5.5	11.0	19.0	222P406B651K
0.0027	5.5	10.5	19.0	272P406B601K	6.0	11.5	19.0	272P406B651K
0.0033	5.5	11.0	19.0	332P406B601K	6.0	12.0	19.0	332P406B651K
0.0039	6.0	11.5	19.0	392P406B601K	5.5	10.0	26.5	392P406B651K
0.0047	6.0	12.0	19.0	472P406B601K	6.0	11.0	26.5	472P406B651K
0.0056	5.0	10.0	26.5	562P406B601K	6.0	12.0	26.5	562P406B651K
0.0068	5.5	11.0	26.5	682P406B601K	6.5	12.5	26.5	682P406B651K
0.0082	6.0	11.5	26.5	822P406B601K	7.0	13.0	26.5	822P406B651K
0.01	6.5	12.0	26.5	103P406B601K	7.5	14.0	26.5	103P406B651K
0.012	6.5	12.5	26.5	123P406B601K	8.0	15.0	26.5	123P406B651K
0.015	7.5	13.0	26.5	153P406B601K	9.0	16.5	26.5	153P406B651K
0.018	8.0	14.0	26.5	183P406B601K	8.5	15.0	32.0	183P406B651K
0.022	8.5	15.0	26.5	223P406B601K	9.0	16.5	32.0	223P406B651K
0.027	8.5	15.0	32.0	273P406B601K	9.5	18.0	32.0	273P406B651K
0.033	9.0	16.5	32.0	333P406B601K	10.0	19.0	32.0	333P406B651K
0.039	9.5	17.5	32.0	393P406B601K	10.0	19.0	45.0	393P406B651K
0.047	9.5	19.0	32.0	473P406B601K	10.5	20.0	45.0	473P406B651K
0.056	10.0	20.0	32.0	563P406B601K	11.5	21.5	45.0	563P406B651K
0.068	11.5	22.0	32.0	683P406B601K	12.5	22.5	45.0	683P406B651K
0.082	10.0	20.0	45.0	823P406B601K	13.5	24.5	45.0	823P406B651K
0.10	11.0	21.0	45.0	104P406B601K	15.5	26.5	45.0	104P406B651K
0.12	12.0	22.0	45.0	124P406B601K	17.0	28.0	45.0	124P406B651K
0.15	13.5	24.5	45.0	154P406B601K	19.5	32.0	45.0	154P406B651K
0.18	15.0	26.0	45.0	184P406B601K	22.0	36.0	45.0	184P406B651K
0.22	17.0	28.0	45.0	224P406B601K	23.0	38.0	45.0	224P406B651K
0.27	19.0	32.0	45.0	274P406B601K				
0.33	22.0	36.0	45.0	334P406B601K				
0.39	24.0	40.0	45.0	394P406B601K				
0.47	26.0	42.0	45.0	474P406B601K				

*Other Values, Voltages, And Dimensions Are Available On Request



Series Wound Metallized Polypropylene Axial Round Wrap & Fill

TYPE: P408 Series

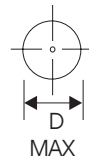
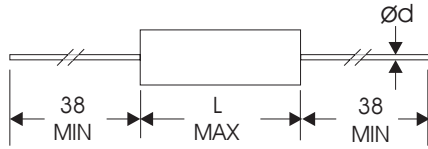

L	19.0	26.5	32.0	45.0
d	0.8	0.8	0.8	1.0

(mm)

CAP. (µF)	630VDC / 400VAC			1000VDC / 500VAC		
	D	L	Part No.	D	L	Part No.
0.001	5.5	19.0	102P408B401K	5.5	19.0	102P408B501K
0.0012	5.5	19.0	122P408B401K	5.5	19.0	122P408B501K
0.0015	5.5	19.0	152P408B401K	5.5	19.0	152P408B501K
0.0018	5.5	19.0	182P408B401K	6.0	19.0	182P408B501K
0.0022	5.5	19.0	222P408B401K	6.0	19.0	222P408B501K
0.0027	5.5	19.0	272P408B401K	6.5	19.0	272P408B501K
0.0033	5.5	19.0	332P408B401K	6.5	19.0	332P408B501K
0.0039	6.0	19.0	392P408B401K	7.0	19.0	392P408B501K
0.0047	6.5	19.0	472P408B401K	7.0	19.0	472P408B501K
0.0056	6.5	19.0	562P408B401K	7.5	19.0	562P408B501K
0.0068	7.0	19.0	682P408B401K	8.0	19.0	682P408B501K
0.0082	7.0	19.0	822P408B401K	8.0	19.0	822P408B501K
0.01	7.0	19.0	103P408B401K	8.5	19.0	103P408B501K
0.012	7.5	19.0	123P408B401K	9.0	19.0	123P408B501K
0.015	8.0	19.0	153P408B401K	9.5	19.0	153P408B501K
0.018	8.5	19.0	183P408B401K	9.0	26.5	183P408B501K
0.022	9.5	19.0	223P408B401K	9.0	26.5	223P408B501K
0.027	8.5	26.5	273P408B401K	10.0	26.5	273P408B501K
0.033	9.0	26.5	333P408B401K	10.5	26.5	333P408B501K
0.039	9.5	26.5	393P408B401K	11.5	26.5	393P408B501K
0.047	10.0	26.5	473P408B401K	12.5	26.5	473P408B501K
0.056	10.5	26.5	563P408B401K	12.0	32.0	563P408B501K
0.068	11.5	26.5	683P408B401K	13.0	32.0	683P408B501K
0.082	11.0	32.0	823P408B401K	14.0	32.0	823P408B501K
0.10	12.0	32.0	104P408B401K	15.0	32.0	104P408B501K
0.12	13.0	32.0	124P408B401K	14.5	45.0	124P408B501K
0.15	14.5	32.0	154P408B401K	16.0	45.0	154P408B501K
0.18	15.5	32.0	184P408B401K	17.0	45.0	184P408B501K
0.22	17.0	32.0	224P408B401K	18.5	45.0	224P408B501K
0.27	15.0	45.0	274P408B401K	20.5	45.0	274P408B501K
0.33	16.0	45.0	334P408B401K	22.5	45.0	334P408B501K
0.39	17.5	45.0	394P408B401K	24.0	45.0	394P408B501K
0.47	19.0	45.0	474P408B401K	26.5	45.0	474P408B501K
0.56	20.5	45.0	564P408B401K	29.0	45.0	564P408B501K
0.68	22.5	45.0	684P408B401K	32.0	45.0	684P408B501K
0.82	24.0	45.0	824P408B401K			
1.0	27.0	45.0	105P408B401K			
CAP. (µF)	1600VDC / 600VAC			2000VDC / 650 VAC		
	D	L	Part No.	D	L	Part No.
0.001	6.5	19.0	102P408B601K	7.5	19.0	102P408B651K
0.0012	7.0	19.0	122P408B601K	7.5	19.0	122P408B651K
0.0015	7.0	19.0	152P408B601K	8.0	19.0	152P408B651K
0.0018	7.5	19.0	182P408B601K	8.0	19.0	182P408B651K
0.0022	7.5	19.0	222P408B601K	8.5	19.0	222P408B651K
0.0027	8.0	19.0	272P408B601K	8.5	19.0	272P408B651K
0.0033	8.5	19.0	332P408B601K	9.0	19.0	332P408B651K
0.0039	8.5	19.0	392P408B601K	8.0	26.5	392P408B651K
0.0047	9.0	19.0	472P408B601K	8.5	26.5	472P408B651K
0.0056	8.0	26.5	562P408B601K	9.0	26.5	562P408B651K
0.0068	8.5	26.5	682P408B601K	9.5	26.5	682P408B651K
0.0082	9.0	26.5	822P408B601K	10.0	26.5	822P408B651K
0.01	9.5	26.5	103P408B601K	11.0	26.5	103P408B651K
0.012	10.0	26.5	123P408B601K	11.5	26.5	123P408B651K
0.015	10.5	26.5	153P408B601K	12.5	26.5	153P408B651K
0.018	11.0	26.5	183P408B601K	12.5	32.0	183P408B651K
0.022	12.0	26.5	223P408B601K	13.0	32.0	223P408B651K
0.027	12.0	32.0	273P408B601K	14.5	32.0	273P408B651K
0.033	12.5	32.0	333P408B601K	15.5	32.0	333P408B651K
0.039	13.5	32.0	393P408B601K	14.5	45.0	393P408B651K
0.047	14.5	32.0	473P408B601K	15.5	45.0	473P408B651K
0.056	15.5	32.0	563P408B601K	17.0	45.0	563P408B651K
0.068	17.0	32.0	683P408B601K	18.0	45.0	683P408B651K
0.082	15.0	45.0	823P408B601K	19.5	45.0	823P408B651K
0.10	16.5	45.0	104P408B601K	21.5	45.0	104P408B651K
0.12	17.5	45.0	124P408B601K	23.0	45.0	124P408B651K
0.15	19.0	45.0	154P408B601K	25.5	45.0	154P408B651K
0.18	21.0	45.0	184P408B601K	28.0	45.0	184P408B651K
0.22	23.0	45.0	224P408B601K	30.5	45.0	224P408B651K
0.27	25.0	45.0	274P408B601K			
0.33	28.0	45.0	334P408B601K			
0.39	31.0	45.0	394P408B601K			
0.47	34.0	45.0	474P408B601K			

*Other Values, Voltages, And Dimensions Are Available On Request