

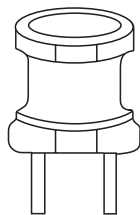

# Fixed Inductors

## D210 Series



Frequency Range: 10-1200kHz  
 Inductance Range: 1.0-1000μH  
 Temperature Coefficient: 400ppm/C, max.

Features: Ideal as a choke coil for noise filtering and DC/DC Converter application.  
 Tape and reel for automated Assembly.

- (1) Q and Inductance are measured by Q meter YHP-4343B equivalent.
- (2) The rated DC current is that which the inductance value decreases 10% by the excitation DC current, measured at 1kHz by Precision LCR meter 4284A(hp) or equivalent.
- (3) SRF is measured by Network Analyzer 3577A(hp), MS560J(Anristu) or equivalent.
- (4) DC Resistance is measured by Digital Multimeter TR6871(Advantest) or equivalent.
- (5) SRF is for Reference Only.

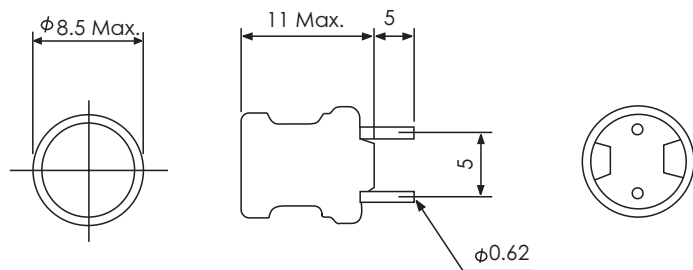

(Unit: mm)

Part Number	Inductance(1)	Qu(1) (min.)	Test Frequency of L, Qu (Mhz)	DC Resistance(4) (Ω) max.	Rated DC Current(2)	Selt Resonant Frequency(3)(5) (MHz) min.
D210-1R0M=R	1.0±20%	20	7.96	0.013	10	150
D210-1R5M=R	1.5±20%	20	7.96	0.016	8.5	130
D210-2R2M=R	2.2±20%	20	7.96	0.021	6.5	100
D210-3R3M=R	3.3±20%	20	7.96	0.025	5.5	79
D210-4R7M=R	4.7±20%	20	7.96	0.030	4.3	51
D210-6R8M=R	6.8±20%	20	7.96	0.035	3.7	29
D210-100K=R	10±10%	50	2.52	0.045	3.0	14
D210-120K=R	12±10%	50	2.52	0.050	2.6	13
D210-150K=R	15±10%	50	2.52	0.056	2.3	12
D210-180K=R	18±10%	40	2.52	0.061	2.2	11
D210-220K=R	22±10%	40	2.52	0.070	2.0	9.2
D210-270K=R	27±10%	40	2.52	0.080	1.7	8.5
D210-330K=R	33±10%	30	2.52	0.090	1.6	7.8
D210-390K=R	39±10%	30	2.52	0.10	1.5	6.9
D210-470K=R	47±10%	30	2.52	0.12	1.4	6.5
D210-560K=R	56±10%	30	2.52	0.18	1.3	5.4
D210-680K=R	68±10%	30	2.52	0.21	1.2	4.9
D210-820K=R	82±10%	30	2.52	0.23	1.1	4.1
D210-101K=R	100±10%	20	0.796	0.28	0.91	3.7
D210-121K=R	120±10%	20	0.796	0.32	0.84	3.4
D210-151K=R	150±10%	20	0.796	0.37	0.75	3.2
D210-181K=R	180±10%	20	0.796	0.58	0.69	2.8
D210-221K=R	220±10%	20	0.796	0.65	0.64	2.7
D210-271K=R	270±10%	20	0.796	0.75	0.57	2.4
D210-331K=R	330±10%	20	0.796	0.85	0.54	2.3
D210-391K=R	390±10%	20	0.796	1.0	0.48	2.1
D210-471K=R	470±10%	20	0.796	1.1	0.46	1.9
D210-561K=R	560±10%	20	0.796	1.4	0.41	1.8
D210-681K=R	680±10%	20	0.796	1.6	0.38	1.6
D210-821K=R	820±10%	20	0.796	1.8	0.35	1.5
D210-102K=R	1000±10%	50	0.252	2.9	0.29	1.3



# Fixed Inductors

## D220 Series

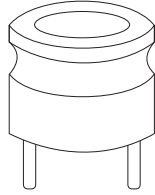

Frequency Range: 10-1200kHz  
 Inductance Range: 0.1-15mH  
 Temperature Coefficient: 400ppm/°C, max.

Features: Ideal as a choke coil or trap coil for low profile equipment.  
 Entire winding core is encapsulated in heat-shrunk plastic housing to provide mechanical and environmental protection.

- (1) Add the tolerance code of Inductance to within the ( ) of the Part Number as follows: J=±5%, K=±10%.
- (2) Q and Inductance are measured by Q meter YHP-4343B or equivalent.
- (3) The rated DC current is that which the inductance value decreases 10% by the excitation DC current, measured at 1kHz by universal bridge or equivalent.
- (4) Self resonant frequency is for reference only.

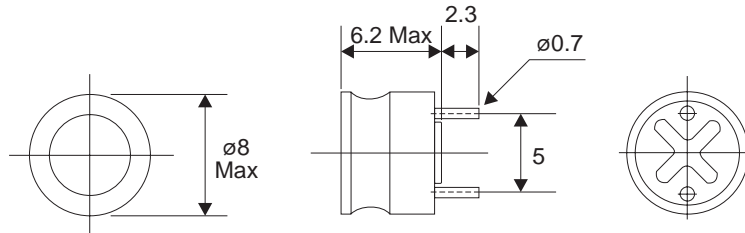

(Unit: mm)

Part Number	Inductance(2) (mH)	Q(2) (min.)	Test Frequency (kHz)	DC Resistance (Ω) max.	Rated DC Current(3) (mA) max.	Self Resonant Frequency(4) (MHz) min.
D220-101K	0.10	60	796	2.0	200	6.1
D220-121K	0.12	60	796	3.0	200	5.5
D220-151K	0.15	60	796	3.0	200	5.0
D220-181K	0.18	60	796	3.0	200	4.7
D220-221K	0.22	60	796	3.0	150	4.5
D220-271K	0.27	60	796	3.0	150	4.1
D220-331K	0.33	60	796	4.0	150	3.8
D220-391K	0.39	60	796	4.0	100	3.5
D220-471K	0.47	60	796	5.0	100	3.2
D220-561K	0.56	60	796	6.0	100	2.9
D220-681K	0.68	60	796	6.0	100	2.7
D220-821K	0.82	60	796	7.0	50	2.3
D220-102K	1.00	80	252	9.0	50	2.1
D220-122K	1.20	80	252	9.0	50	1.9
D220-152K	1.50	80	252	11.0	50	1.8
D220-182K	1.80	80	252	12.0	50	1.6
D220-222K	2.20	80	252	14.0	50	1.5
D220-272K	2.70	80	252	15.0	50	1.4
D220-332K	3.30	80	252	25.0	40	0.9
D220-392K	3.90	80	252	30.0	40	0.9
D220-472K	4.70	80	252	32.0	40	0.8
D220-562K	5.60	80	252	36.0	30	0.7
D220-682K	6.80	80	252	40.0	30	0.7
D220-882K	8.20	80	252	45.0	30	0.6
D220-103( )	10.00	60	079.6	55.0	20	0.6
D220-123( )	12.00	60	079.6	65.0	20	0.5
D220-153( )	15.00	60	079.6	80.0	20	0.5